



This all new **LCG Class 1 chassis system** is a universal design for portal axles, preferably Traxxas TRX4 or Axial AR45.

Designed with **state of the art 3D modeling software** to optimize suspension geometry, component location and **center of gravity**.

Kit features:

- Divorced primary drive with a compact and lightweight **Generation 2** transfer case
- Stainless Steel primary drive and transfer case shafts
- Stainless Steel screws, nuts and miscellaneous hardware
- Genuine **Vanquish Incision** 52t 32p spur gear included
- Excellent weight distribution, low center of gravity
- Improved suspension geometry with built in anti squat and a low instant center
- Steel prop shaft with brass pivot balls
- Your choice of 2 skid plates: Standard for 540/550 motors and Extended for shorter outrunner style motors up to 40mm in length
- 3mm Carbon Fiber matte twill weave frame rails with integrated shock mounts
- 3mm Carbon Fiber matte twill weave motor mount plate
- Lay down servo mount
- Included sliders are intended for use with the **RC4WD "Mojave" SWB Hard body**
- 11.4" approximate wheelbase
- For optimum performance a **full droop setup front and rear is recommended**. Just add your axles, links, driveshafts, shocks and electronics package and hit the rocks!

! CAUTION !

DO NOT OVERTIGHTEN SCREWS INTO 3D PRINTED PARTS. POWERED SCREWDRIVERS GENERATE HEAT WHEN INSTALLING SCREWS. IF YOU ARE USING A POWERED SCREWDRIVER, INSTALL TO 75% DEPTH AND LET THE PLASTIC COOL OFF. HAND TIGHTEN TO 100%.

STRIPPED HOLES ARE NOT COVERED UNDER WARRANTY!

Please read this entire instruction book prior to assembly



F-BH40 - (2)
M3x40mm Button Head



F-BH08 - (2)
M3x8mm Button Head



F-SS16 - (4)
M3x16mm Set Screw



F-BH35 - (2)
M3x35mm Button Head



F-BH06 - (3)
M3x6mm Button Head

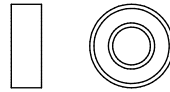

D-B5114 - (5)
5x11x4 Bearing



F-BH25 - (4)
M3x25mm Button Head



F-EC04 - (3)
4mm E Clip

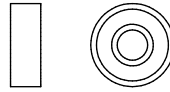

D-B4114 - (1)
4x11x4 Bearing



F-BH20 - (3)
M3x20mm Button Head



C-SP33 - (2)
3x3 Spacer



D-B4104-F - (1)
4x10x4 Bearing Flanged



F-BH18 - (3)
M3x18mm Button Head



C-SP35 - (4)
3x5 Spacer



D-B5104-F - (1)
5x10x4 Bearing Flanged



F-BH16 - (2)
M3x16mm Button Head



C-SP36 - (1)
3x6 Spacer



F-BH12 - (12)
M3x12mm Button Head



D-SP55 - (1)
5x5 Spacer



F-LN03 - (6)
3mm Locknut

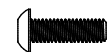

F-BH10 - (12)
M3x10mm Button Head



F-FW04 - (1)
4mm Flat Washer

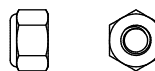

F-LN04 - (1)
M4mm Lock Nut

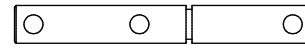

D-TCBS - (1)
Transfer Case Bottom Shaft

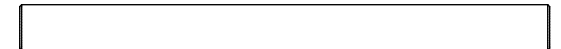

C-SP70 - (3)
M3x70mm Chassis Spacer

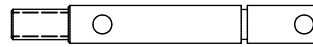

D-TS - (1)
Transmission Shaft

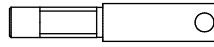

D-TCTS - (1)
Transfer Case Top Shaft

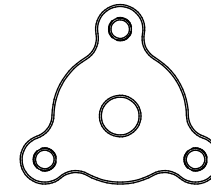

D-NGSA - (1)
Spur Adapter v2

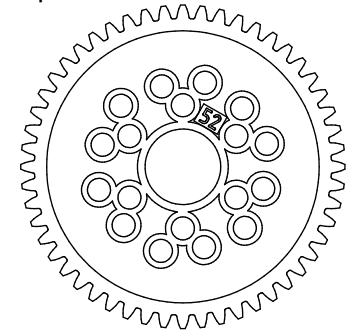

D-SG52 - (1)
Incision 52t Spur



D-DP10 - (2)
2.5mm x 10mm Dowel Pin

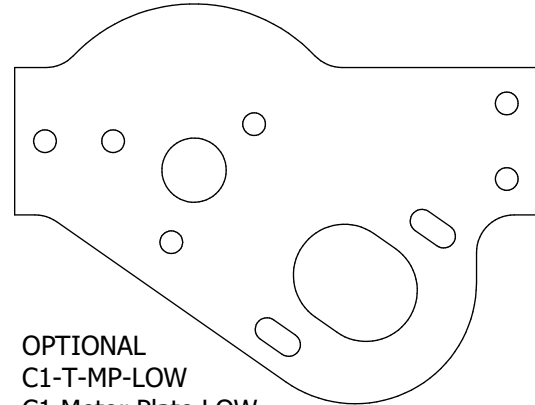

OPTIONAL
C1-T-MP-LOW
C1 Motor Plate LOW

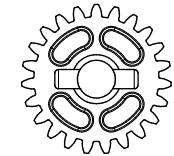

D-PX-GEAR-23 - (1)
23t Bottom Gear

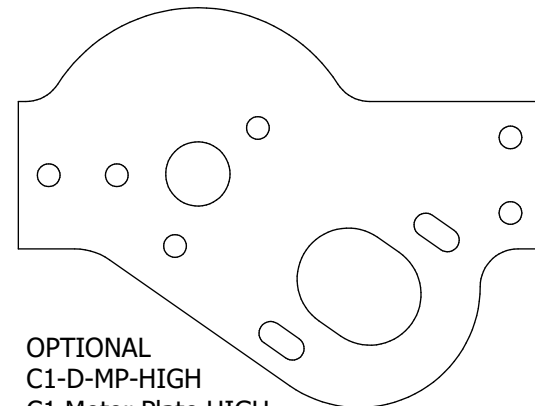

OPTIONAL
C1-D-MP-HIGH
C1 Motor Plate HIGH

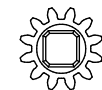

D-PX-GEAR-12 - (1)
12t Top Gear

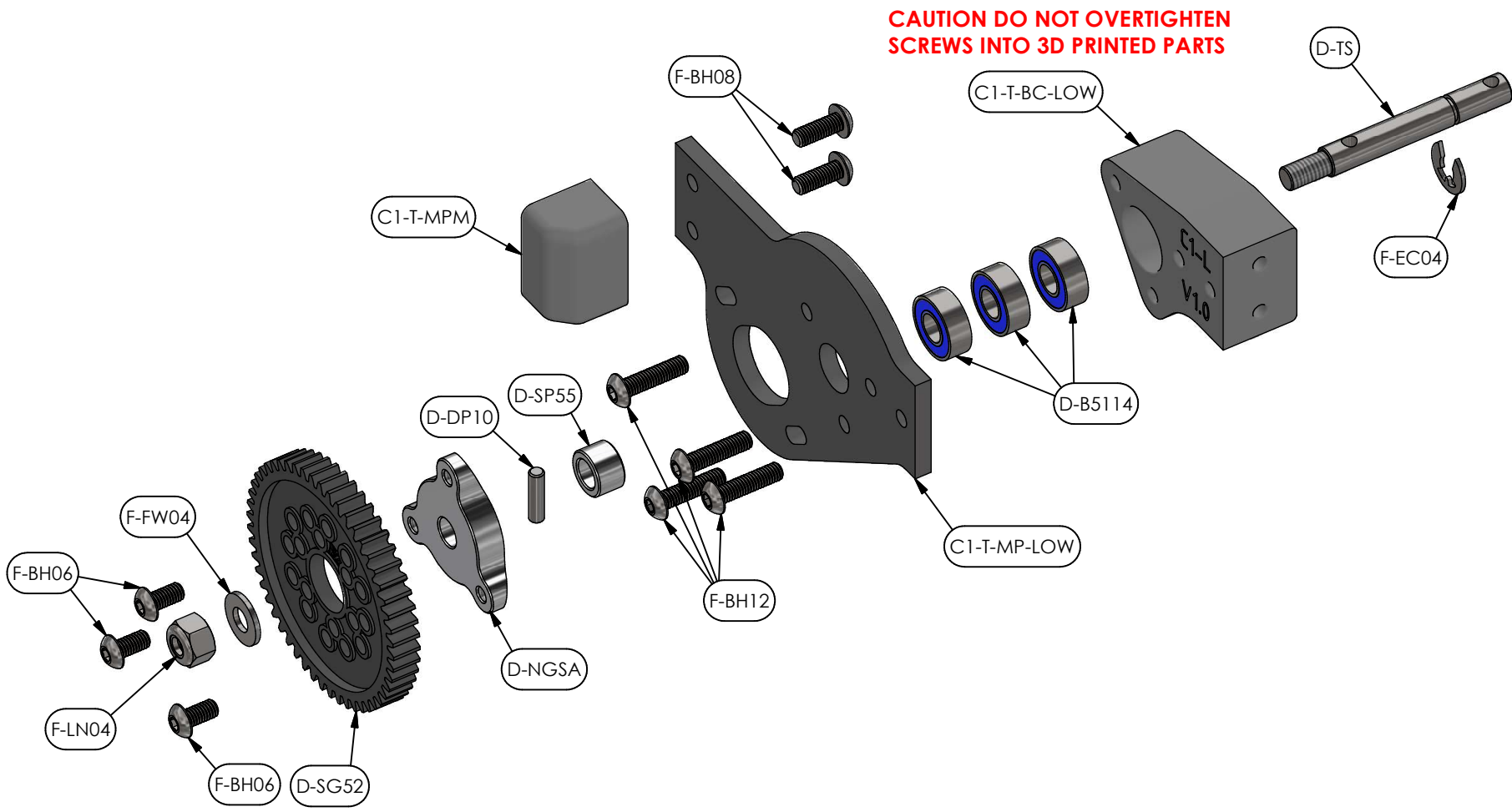

**CAUTION DO NOT OVERTIGHTEN
SCREWS INTO 3D PRINTED PARTS**

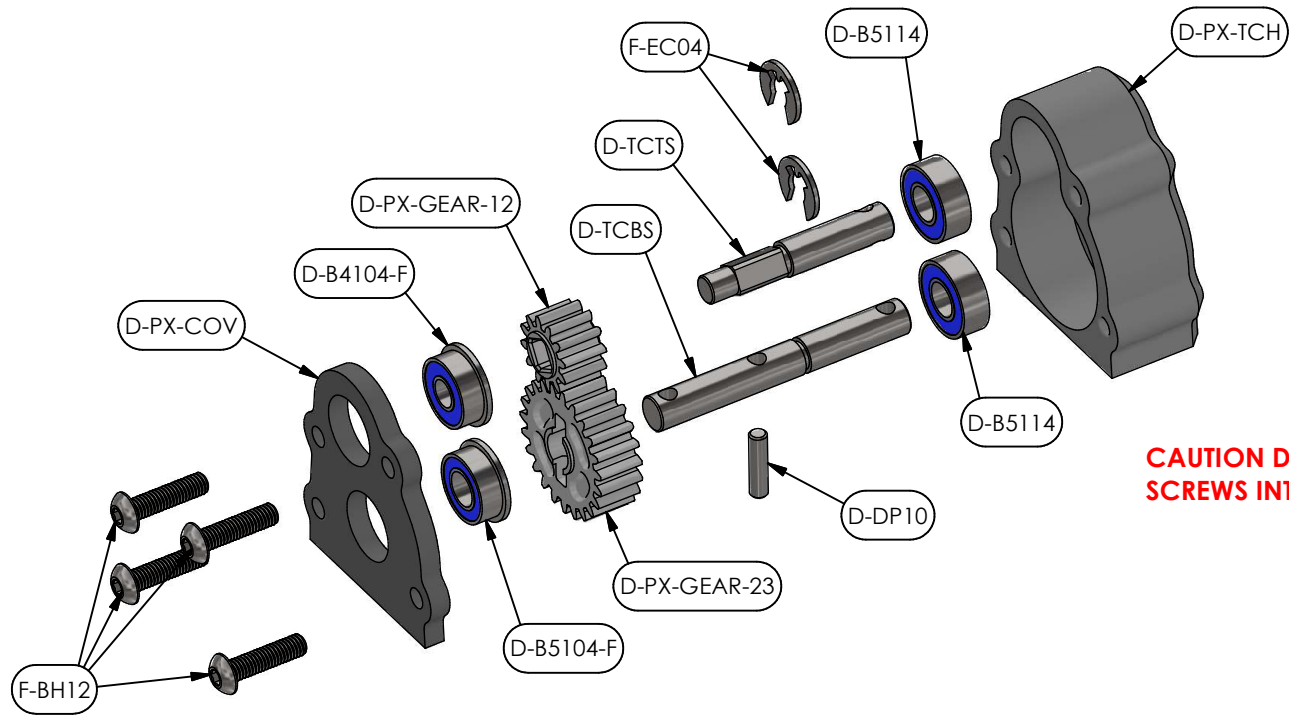

CAUTION DO NOT OVERTIGHTEN SCREWS INTO 3D PRINTED PARTS

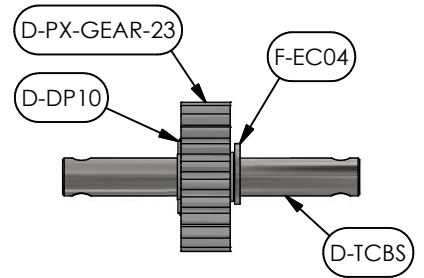

- BOTTOM SHAFT ASSEMBLY ORDER:**
1. CROSS PIN
 2. GEAR
 3. E-CLIP

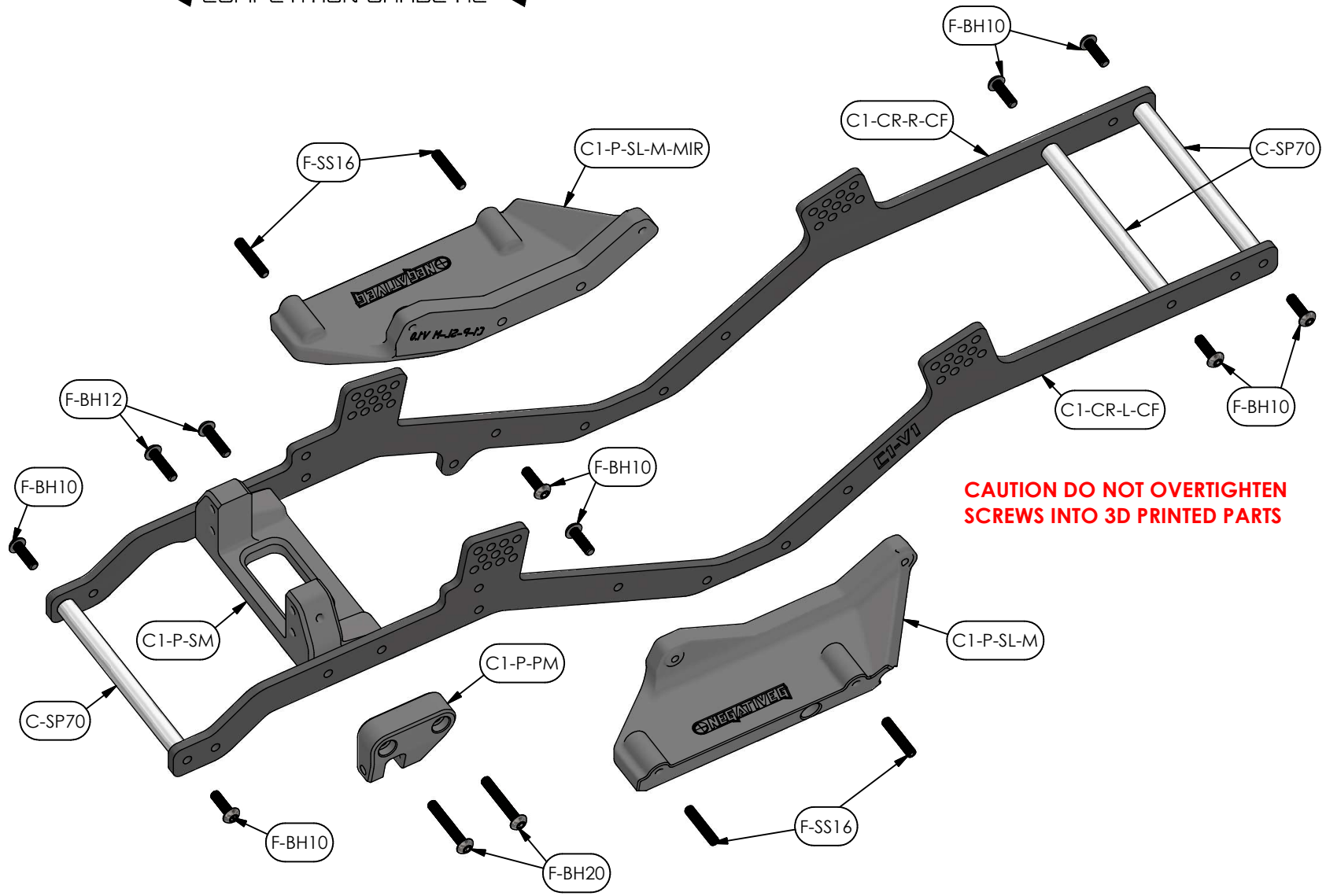

**CAUTION DO NOT OVERTIGHTEN
SCREWS INTO 3D PRINTED PARTS**

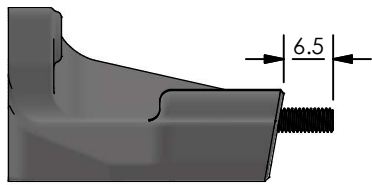

**F-SS16 SHOULD BE PARALLEL
WITH BOTTOM OF SLIDER**

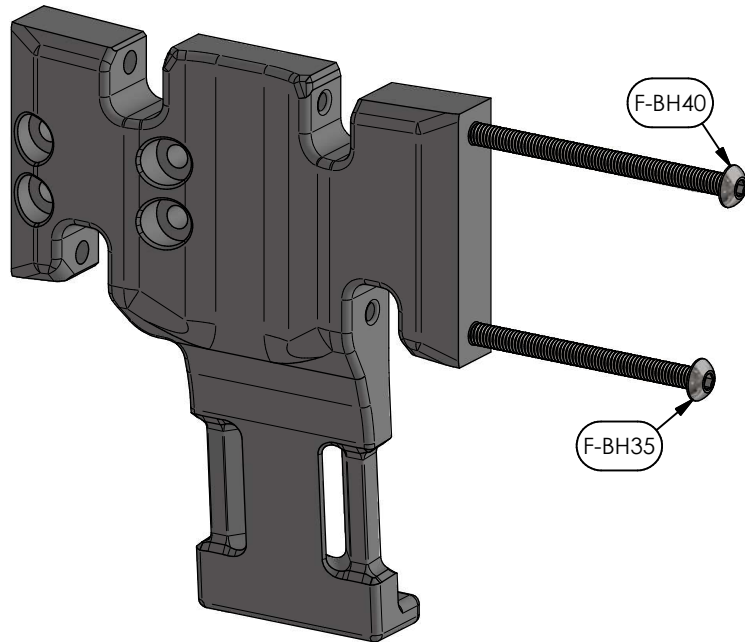

USING A POWERED SCREWDRIVER INSTALL (1) LINK SCREW AT A TIME FULL DEPTH INTO EACH SKID PLATE LINK SCREW HOLE (F-BH40 FOR REAR, F-BH35 FOR FRONT). DO THIS IN STEPS TO AVOID OVERHEATING THE PLASTIC. INSTALL 30% AND LET COOL, REPEAT TO 60%, THEN TO 90% AND FINALLY FULL DEPTH.

AFTER EACH HOLE HAS BEEN THREADED AND THE SCREW REMOVED, USE AN ALLEN KEY OR COMPRESSED AIR TO CLEAN THE DEBRIS OUT OF THE HOLE, THEN MOVE ON TO THE NEXT ONE. SKIPPING THIS STEP MAY CAUSE THE SCREWS TO BIND INSIDE THE HOLE WHICH WILL PREVENT REMOVAL AND VOID THE WARRANTY.

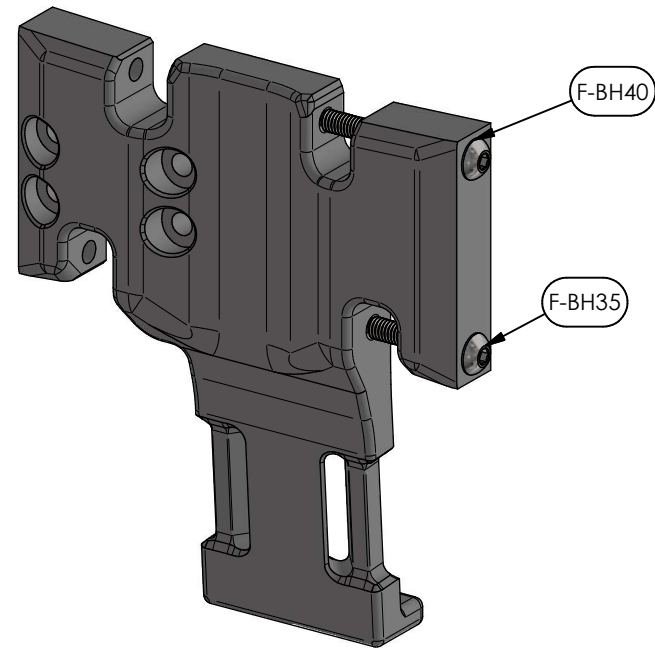

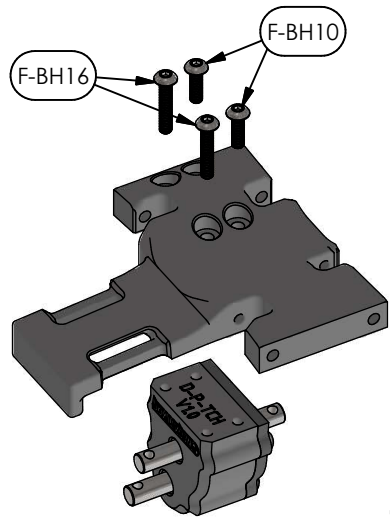

**CAUTION DO NOT OVERTIGHTEN
SCREWS INTO 3D PRINTED PARTS**

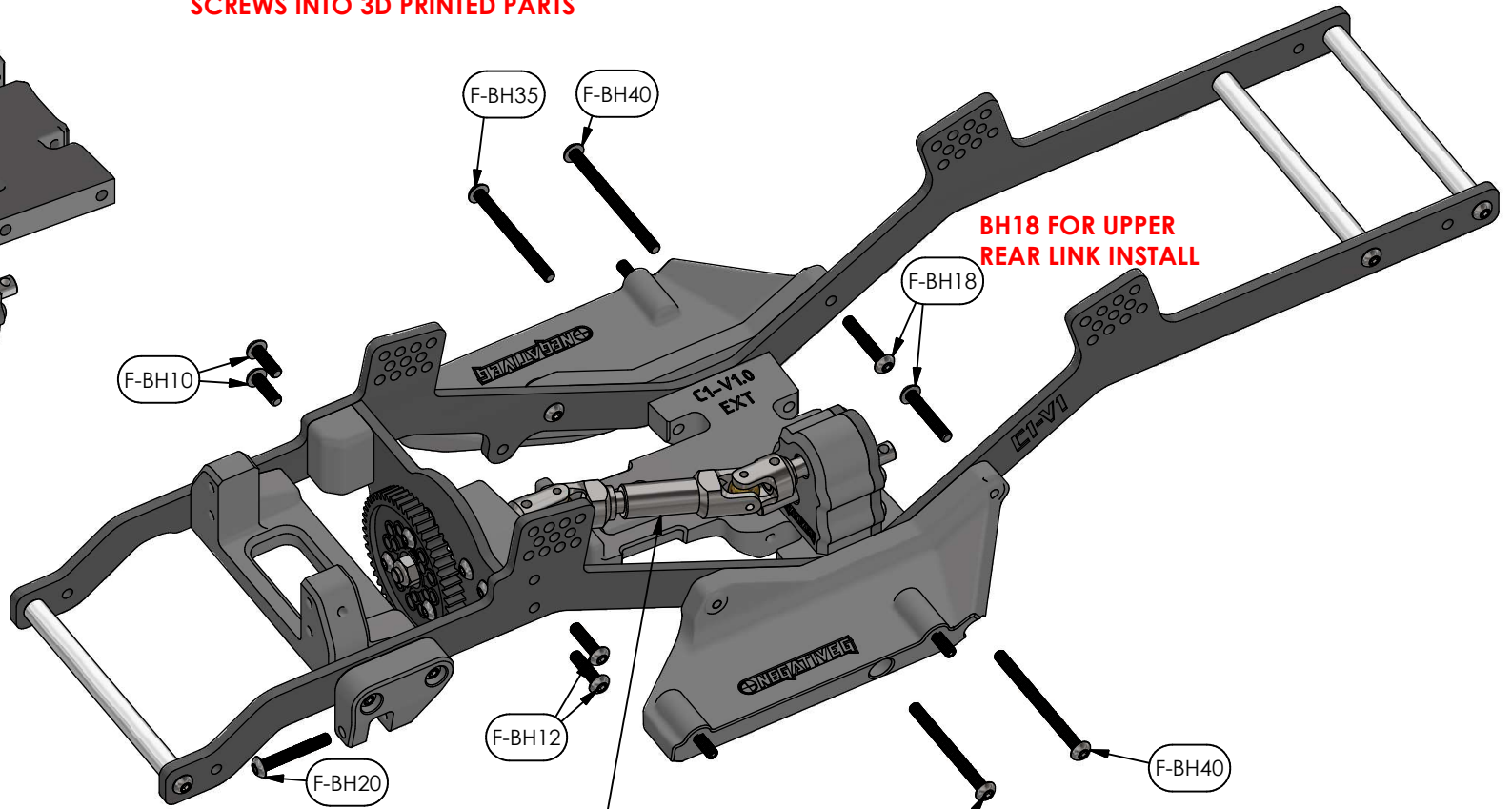

**BH18 FOR UPPER
REAR LINK INSTALL**

**INSTALL PROPSHAFT HALVES TO PRIMARY DRIVE AND
TRANSFER CASE PRIOR TO TRANSFER CASE INSTALL.
CHECK FOR CORRECT PROPSHAFT UJOINT PHASING**

**BH35/40 FOR
LOWER LINK
INSTALL**

CORRECT PHASING

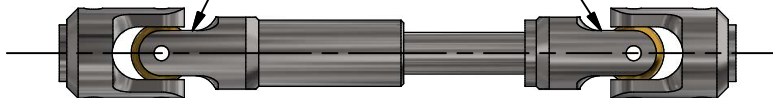

LINK LENGTHS FOR TRX4 AXLES

ALL LENGTHS ARE APPROXIMATE. HIGHLY RECOMMENDED TO ORDER
1+- MM SHORTER FOR ADJUSTMENT

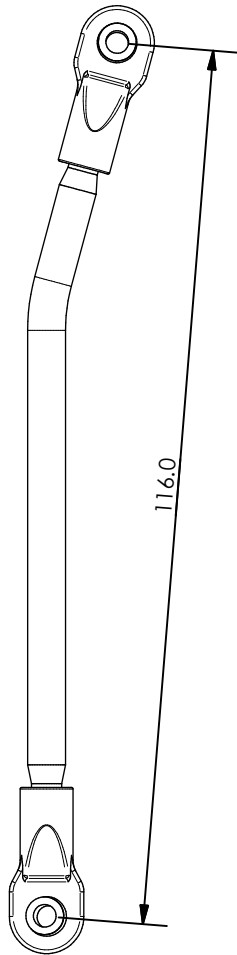

FRONT AND REAR
LOWER LINK
QTY (4)

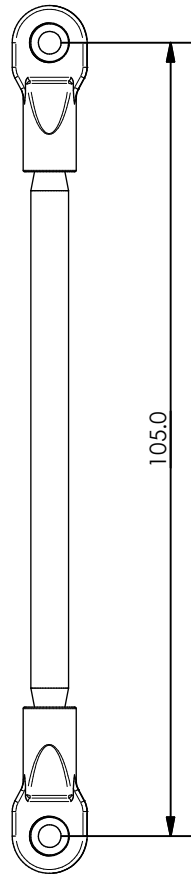

UPPER REAR LINK
QTY (2)

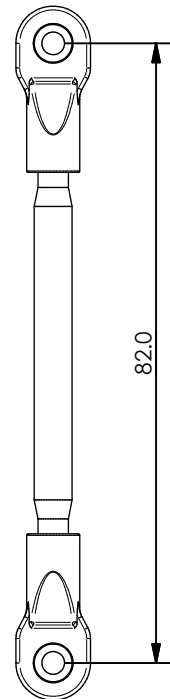

UPPER FRONT LINK
QTY (1)

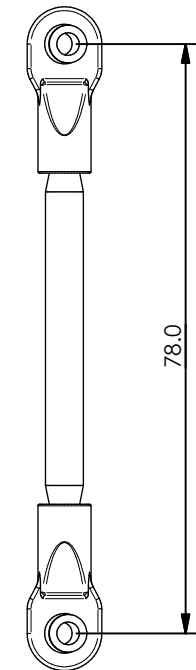

PANHARD LINK
QTY (1)

LINK LENGTHS FOR AR45 AXLES

ALL LENGTHS ARE APPROXIMATE. HIGHLY RECOMMENDED TO ORDER
1+- MM SHORTER FOR ADJUSTMENT

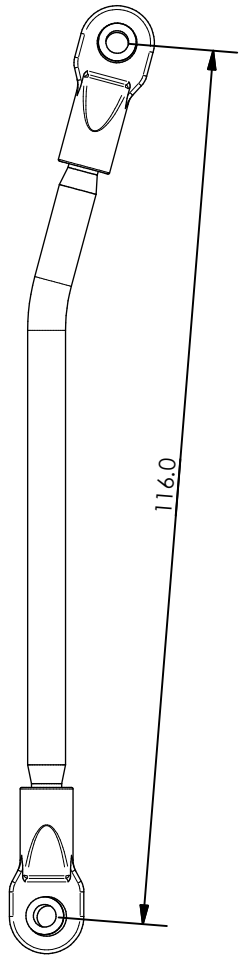

FRONT AND REAR
LOWER LINK
QTY (4)

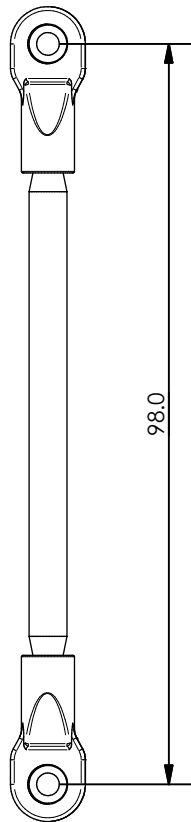

UPPER REAR LINK
QTY (2)

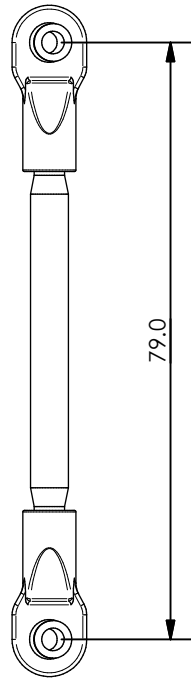

UPPER FRONT LINK
QTY (1)

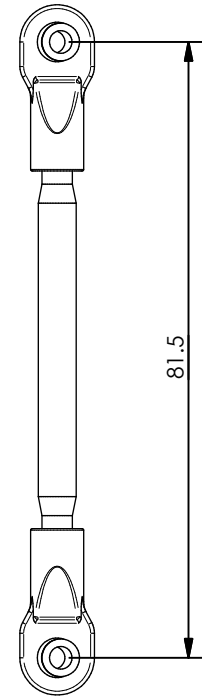

PANHARD LINK
QTY (1)

LINK LENGTHS FOR F10 AXLES

ALL LENGTHS ARE APPROXIMATE. HIGHLY RECOMMENDED TO ORDER 1+- MM SHORTER FOR ADJUSTMENT

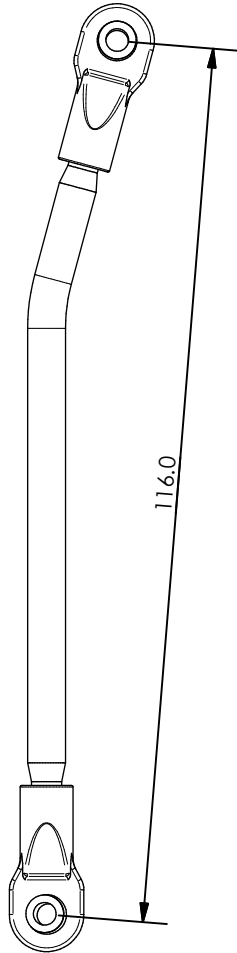

FRONT AND REAR
LOWER LINK
QTY (4)

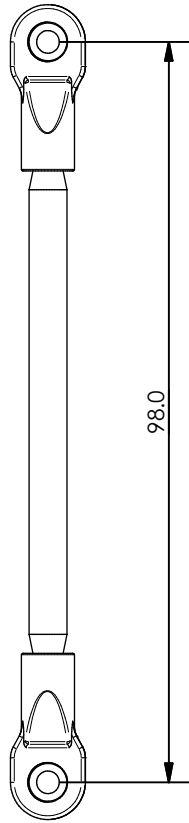

UPPER REAR LINK
QTY (2)

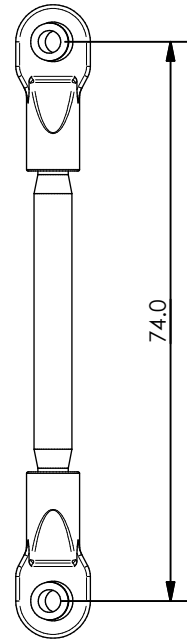

UPPER FRONT LINK
QTY (1)

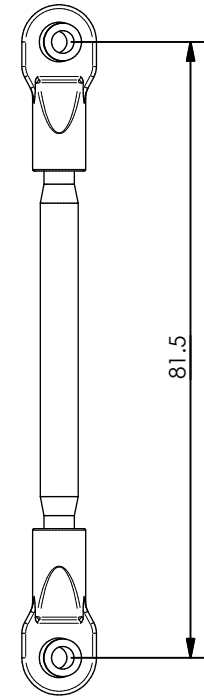

PANHARD LINK
QTY (1)

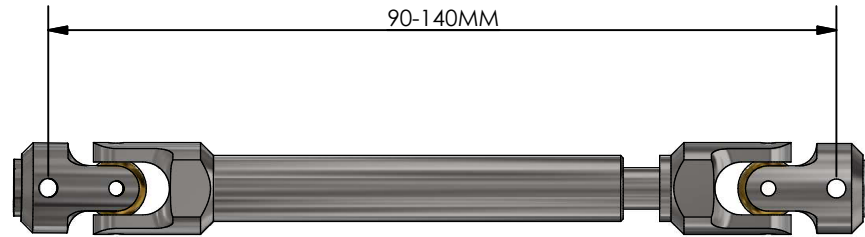

RECOMMENDED DRIVESHAFT
FRONT AND REAR
90MM - 140MM

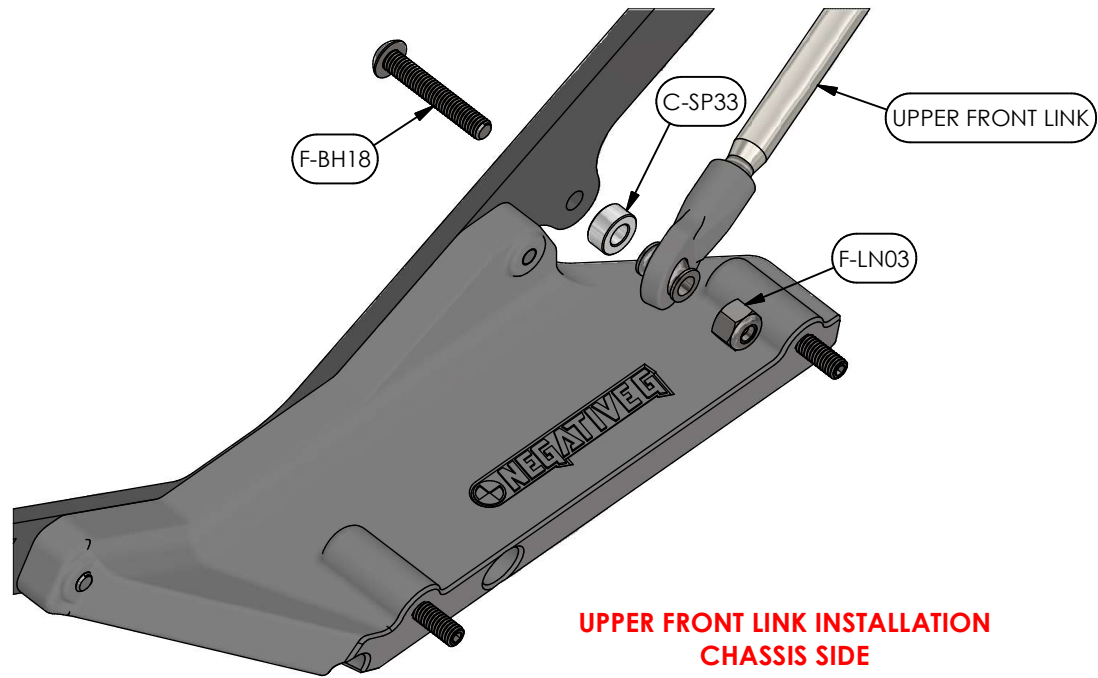

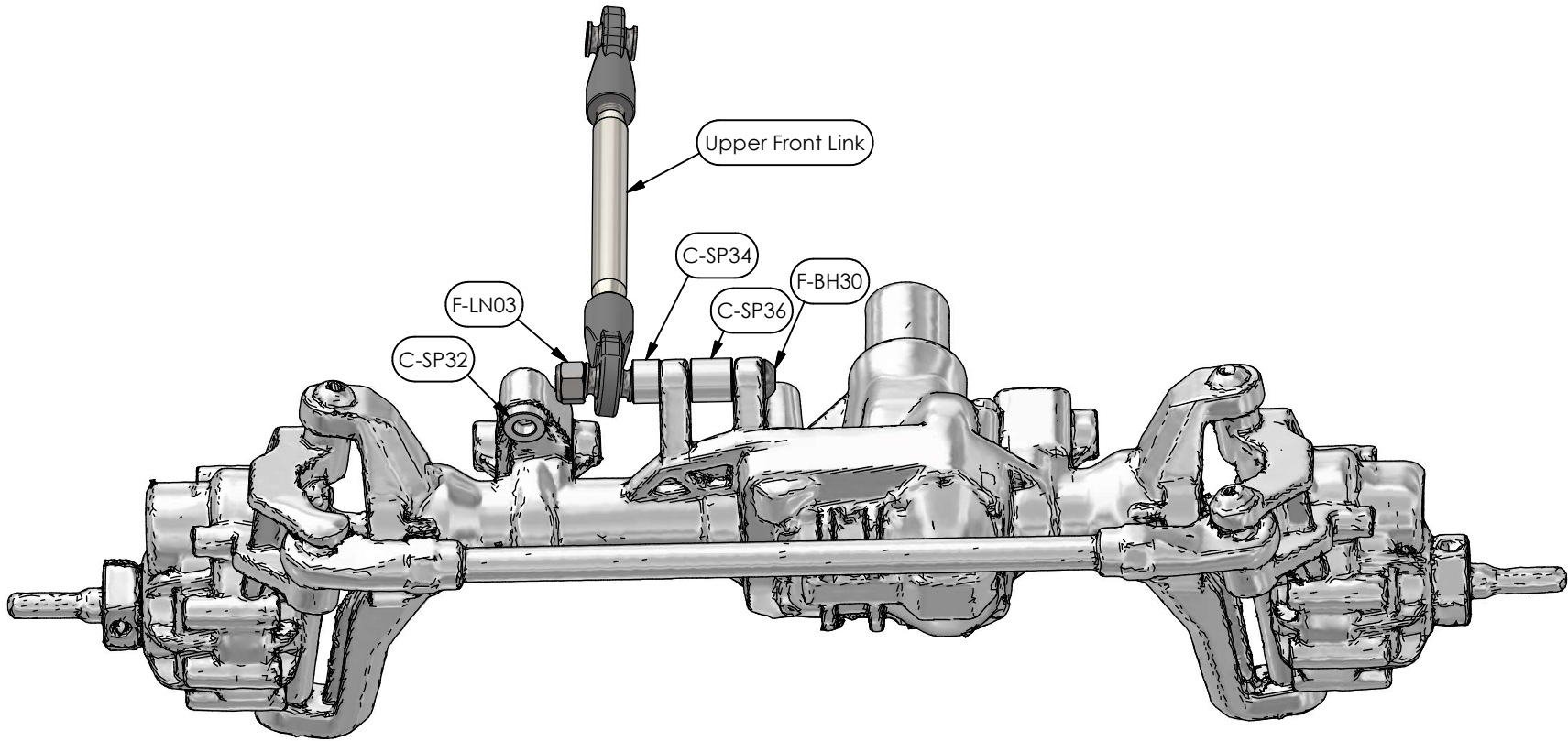

TRX4 UPPER FRONT LINK INSTALLATION
***HARDWARE LOCATED IN MOTOR PLATE BAG**

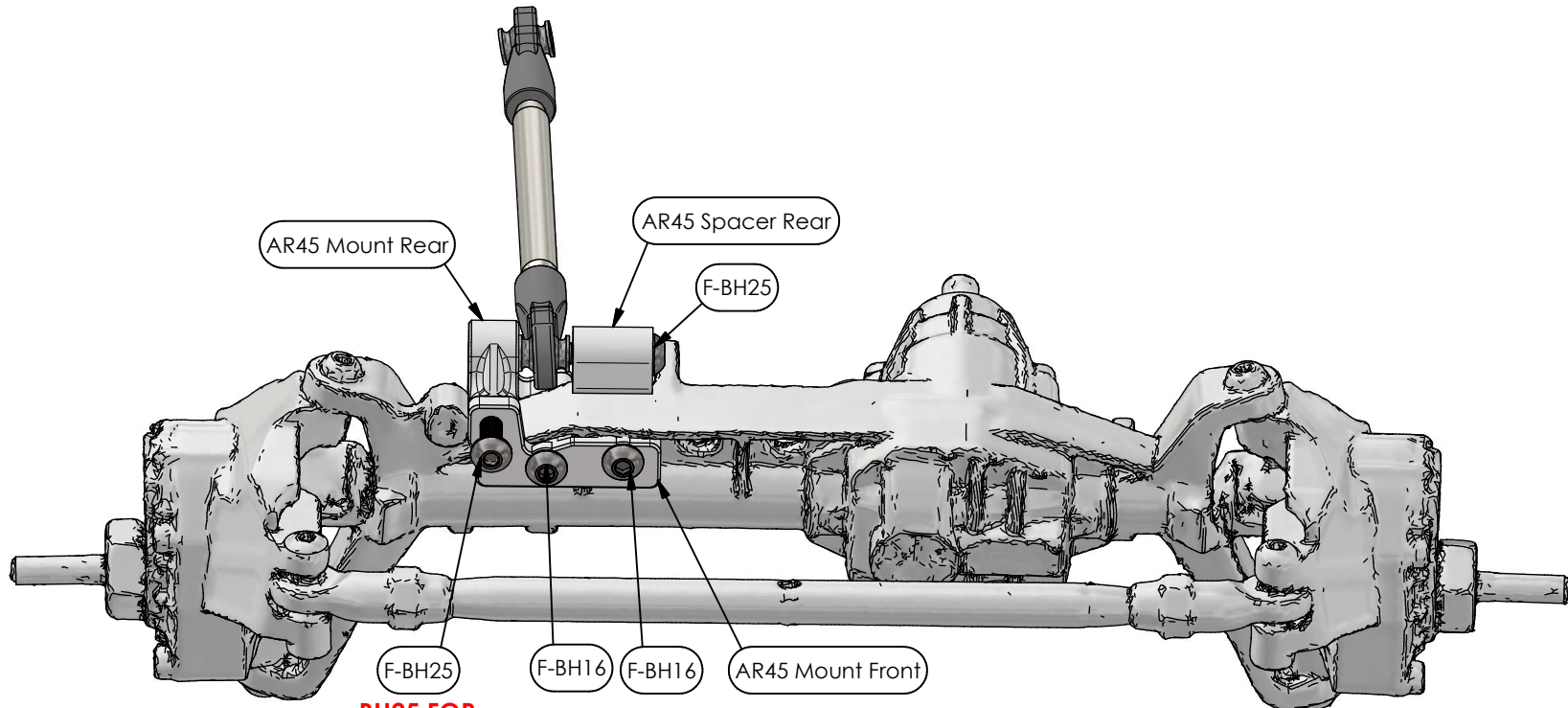

**BH25 FOR
PANHARD**

**AR45 FRONT UPPER LINK INSTALLATION
*HARDWARE LOCATED IN MOTOR PLATE BAG**

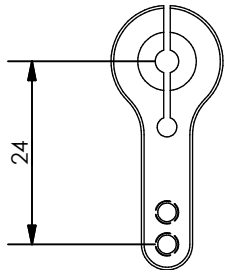

**MINIMUM 24MM SERVO
HORN RECOMMENDED**

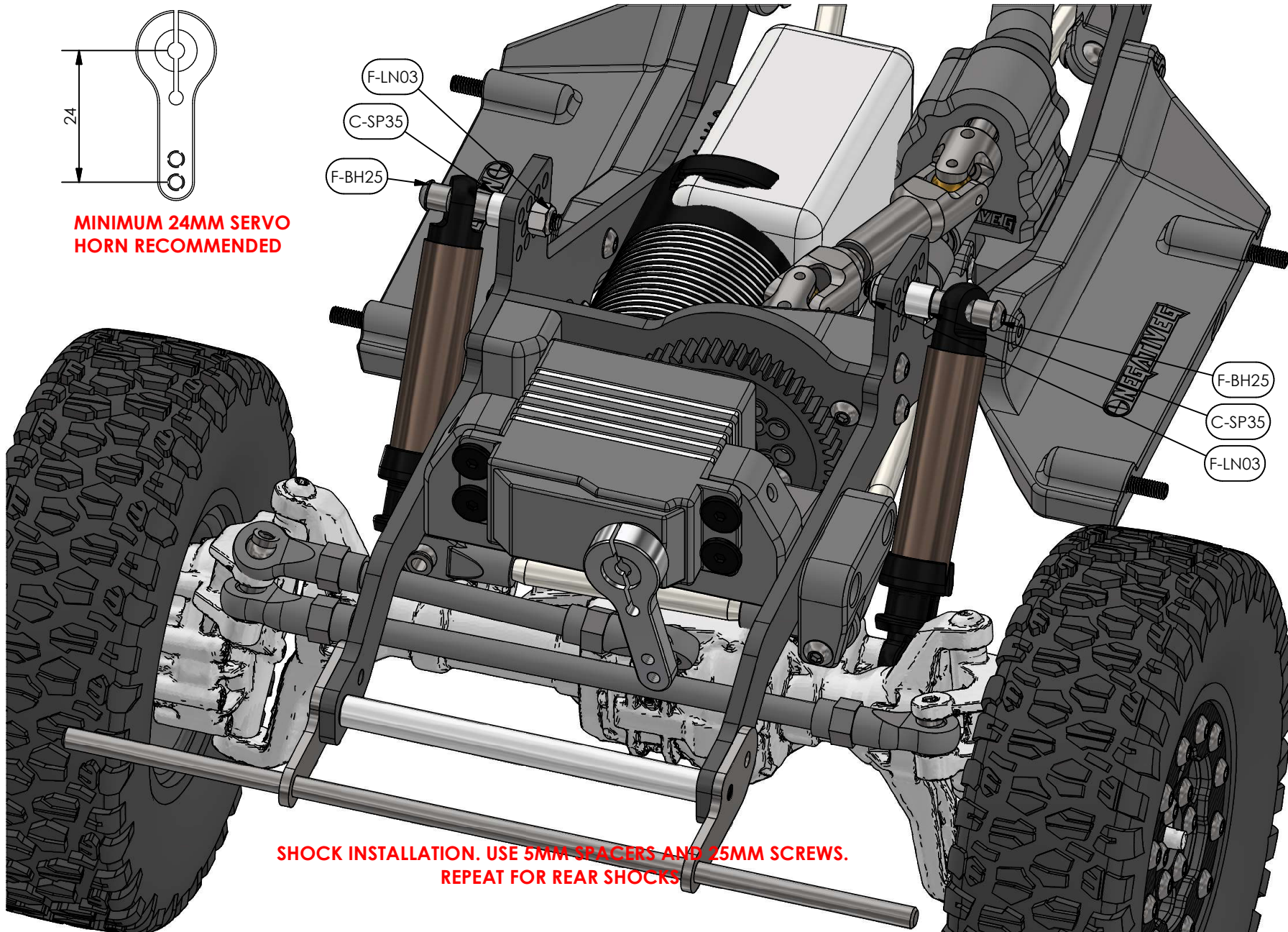

**SHOCK INSTALLATION. USE 5MM SPACERS AND 25MM SCREWS.
REPEAT FOR REAR SHOCKS**



RECOMMENDED SETUP

- RUN AS FULL DROOP
- SOFT OR MEDIUM SPRINGS
- RUBBER BAND LIMIT STRAPS F&R

DON'T LET GRAVITY WIN!