

# Welcome to the NEGATIVE G RC Family!

This all new **LCG crawler chassis system** is designed specifically for the **313mm/12.3" wheelbase TRX-4 platform**.

Designed with **state of the art 3D modeling software** to optimize suspension geometry, component location and **center of gravity**.

Kit features:

- All new "divorced" primary drive and an extremely compact and lightweight transfer case
- Stainless Steel primary drive and transfer case shafts
- Stainless Steel screws, nuts and misc hardware
- Genuine Kimbrough 50t 32p spur gear included (50t-54t limit)
- Excellent weight distribution, low center of gravity
- Improved suspension geometry with built in anti squat and a low instant center
- Includes adjustable droop strap (rubber band) mount at the rear
- 3D printed parts are made from a proprietary blend of plastics for terrific impact and heat resistance
- For optimum performance a **full droop setup front and rear is recommended**. Just add your axles, links, driveshafts, shocks and electronics package and hit the rocks!

## Optional Pars:

- 6mm or 8mm front bumper bar
- Short or long center skid plate depending on motor size

## Builders Tips:

- Add a miniscule smear of grease to screws intended for 3d printed parts. This eases installation and aids in anti-galling. Use low RPM screwdriver for installation. Power tighten to 85% and hand tighten to 100%. **See Figure 1 below.**
- Do not over tighten front upper link rod ends to link bar. Washers may be used in between links and rod end to achieve desired pinion angle.
- Some minor length adjustment to the stock Traxxas panhard rod may be required to center axle. Check axle centering at full compression.

## Required parts not included:

- Traxxas TRX-4 Axles, suspensions links, drive shafts and shocks
- Traxxas 3931 3x8 flanged screws or equivalent
- Traxxas 8115 body mount kit
- Electronics package
- Wheels/tires
- Body

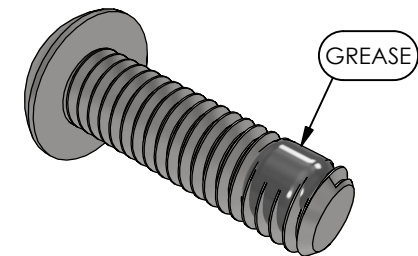

FIGURE 1



F-BH30 - (9)  
M3x30mm Button Head



F-SS16 - (2)  
M3x16mm Set Screw



C-SP33 - (1)  
3x3 Spacer

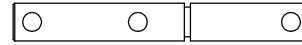

D-TCBS - (1)  
Transfer Case Bottom Shaft

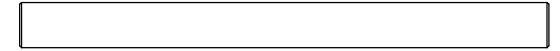

C-SP70 - (2)  
70mm Chassis Spacer



F-BH25 - (4)  
M3x25mm Button Head



D-B5114 - (6)  
5x11x4 Bearing



C-SP34 - (1)  
3x4 Spacer



D-PDMS - (1)  
Transmission Shaft



C-LKUF50 - (1)  
Upper Front Link



F-BH20 - (2)  
M3x20mm Button Head



D-B4114 - (1)  
4x11x4 Bearing



C-SP35 - (4)  
3x5 Spacer

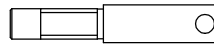

D-TCTS - (1)  
Transfer Case Top Shaft



C-REAN - (2)  
Rod End Angled



F-BH18 - (3)  
M3x18mm Button Head



D-DP10 - (1)  
2.5mm x 10mm Dowel Pin



C-SP36 - (1)  
3x6 Spacer

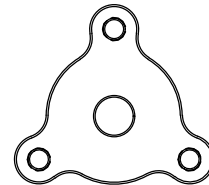

D-NGSA - (1)  
Spur Adapter v2



F-EC04 - (3)  
4mm E Clip



F-BH16 - (12)  
M3x16mm Button Head



D-DP12 - (1)  
2.5mm x 12mm Dowel Pin



D-SP55 - (1)  
5x5 Spacer



D-SG52 - (1)  
Incision 52t Spur



F-BH12 - (6)  
M3x12mm Button Head



F-LN03 - (4)  
3mm Locknut



F-FW04 - (1)  
4mm Flat Washer



D-TCTG - (1)  
Transfer Case Top Gear

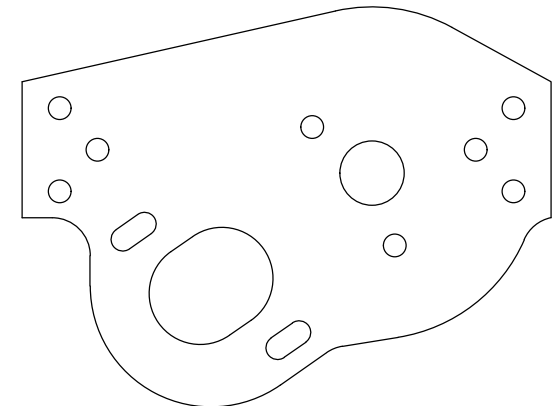

D-PDMP - (1)  
Carbon Fiber Motor Plate



F-BH10 - (24)  
M3x10mm Button Head



F-LN04 - (1)  
M4mm Lock Nut

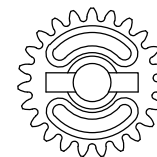

D-TCBG - (1)  
Transfer Case Bottom Gear



F-BH06 - (3)  
M3x6mm Button Head

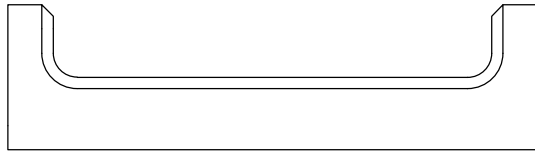

C-3DFB - (1)  
Front Bumper

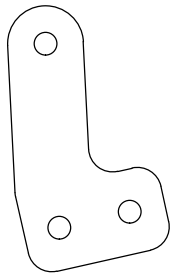

C-BUCF - (2)  
Front Bumper Upright-Carbon Fiber

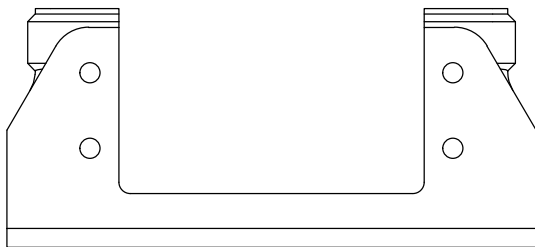

C-3DSM - (1)  
Servo Mount

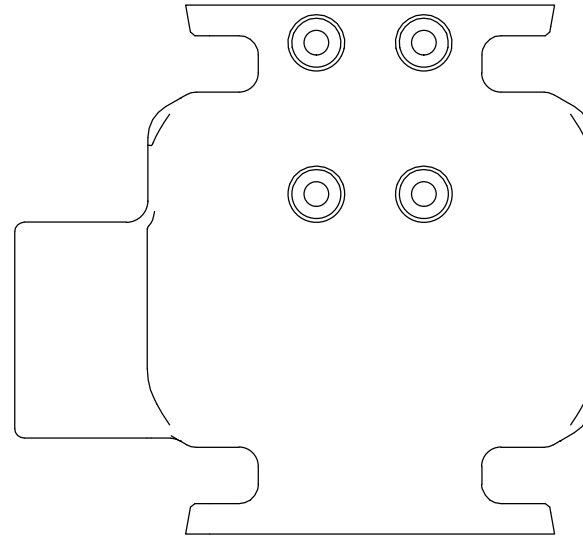

C-3DSS - (1)  
Center Skid - Standard

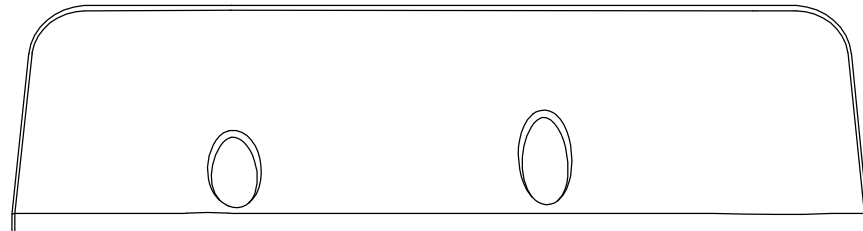

C-3DSR - (1)  
Narrow Slider Right

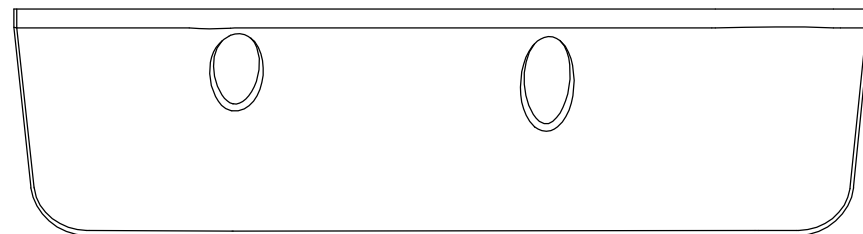

C-3DSL - (1)  
Narrow Slider Left

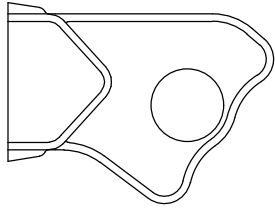

D-PDBC - (1)  
Trans Shaft Bearing Case

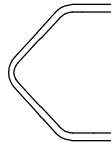

D-PDSM - (1)  
Trans Side Mount

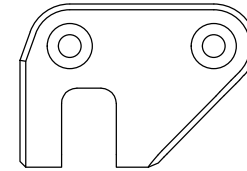

C-3DPM - (1)  
Panhard Bar Mount

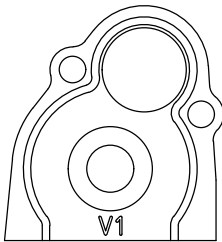

D-TCRE - (1)  
Transfer Case Rear Half

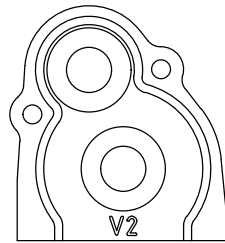

D-TCFR - (1)  
Transfer Case Front Half

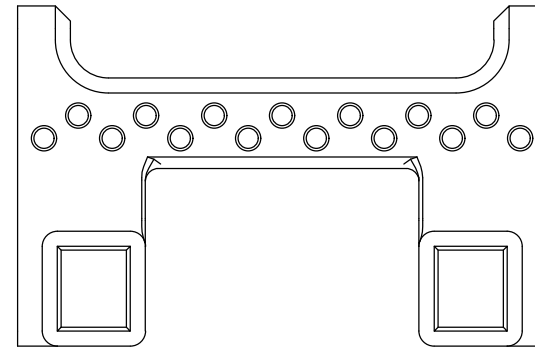

C-3DBR - (1)  
Rear Body Mount

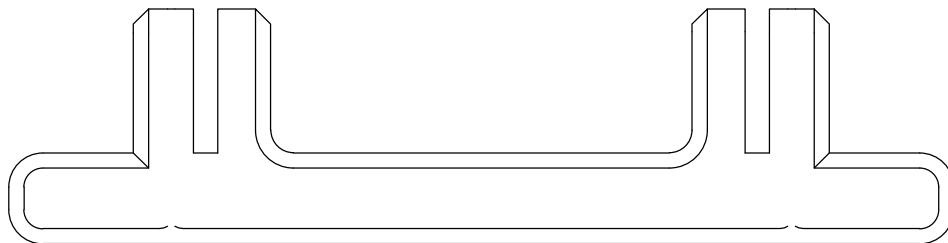

C-3DRB - (1)  
Rear Bumper

**CAUTION DO NOT OVERTIGHTEN  
SCREWS INTO 3D PRINTED PARTS**

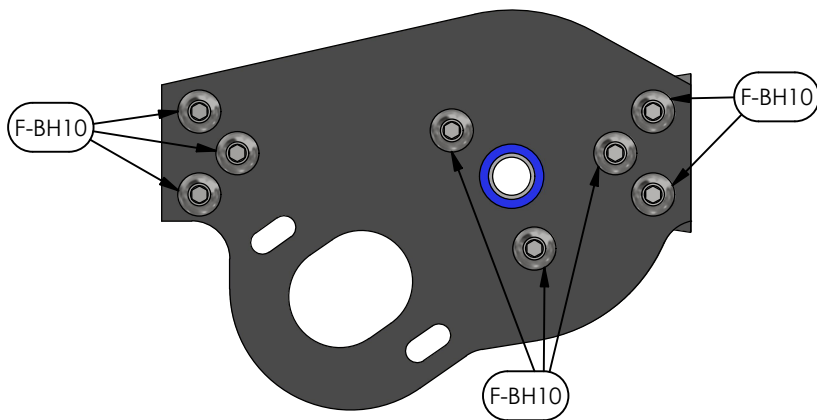
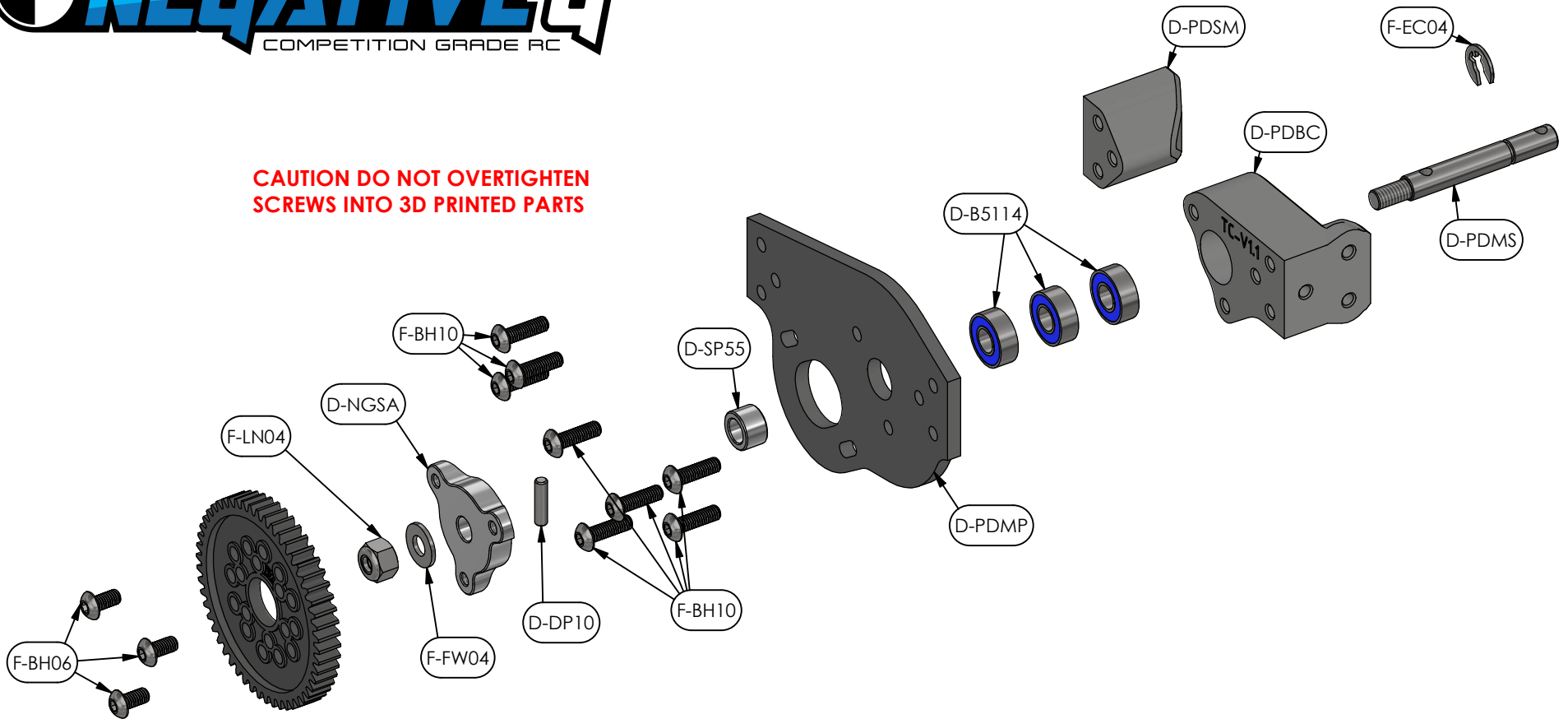

FRONT VIEW



F-EC04 - (1)  
4mm E Clip



D-SP55 x 1  
5x5 Spacer



F-LN04 x 1  
4mm Lock Nut

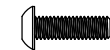

F-BH10 - (8)  
M3x10mm Button Head



F-BH06 - (3)  
M3x6mm Button Head

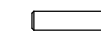

D-DP10 - (1)  
2.5mm x 10mm Dowel Pin

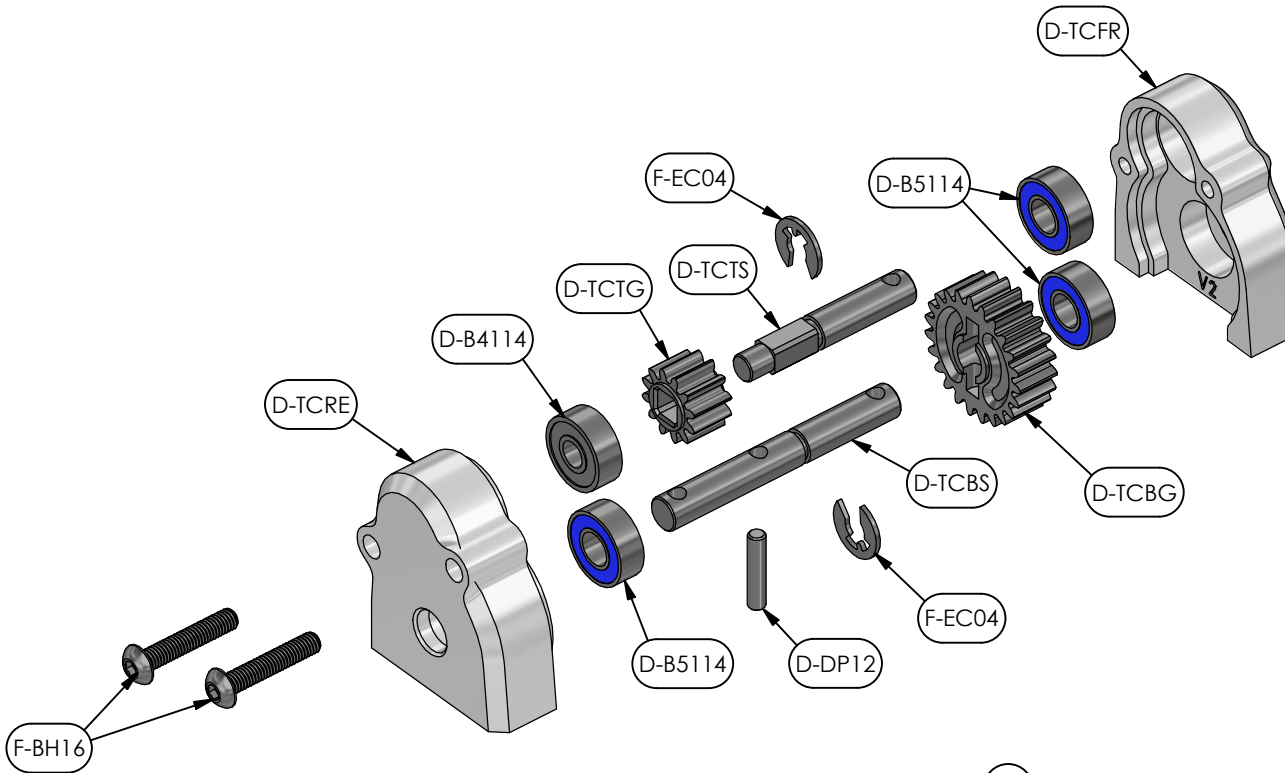

**CAUTION DO NOT OVERTIGHTEN  
SCREWS INTO 3D PRINTED PARTS**

**MINIMAL GREASE REQUIRED**

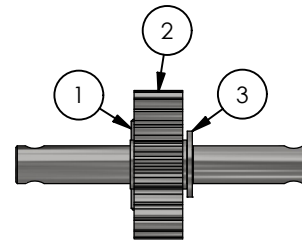

**BOTTOM SHAFT ASSEMBLY ORDER:**

1. CROSS PIN
2. GEAR
3. E-CLIP

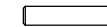

D-DP12 - (1)  
2.5mm x 12mm Dowel Pin



F-EC04 - (2)  
4mm E Clip





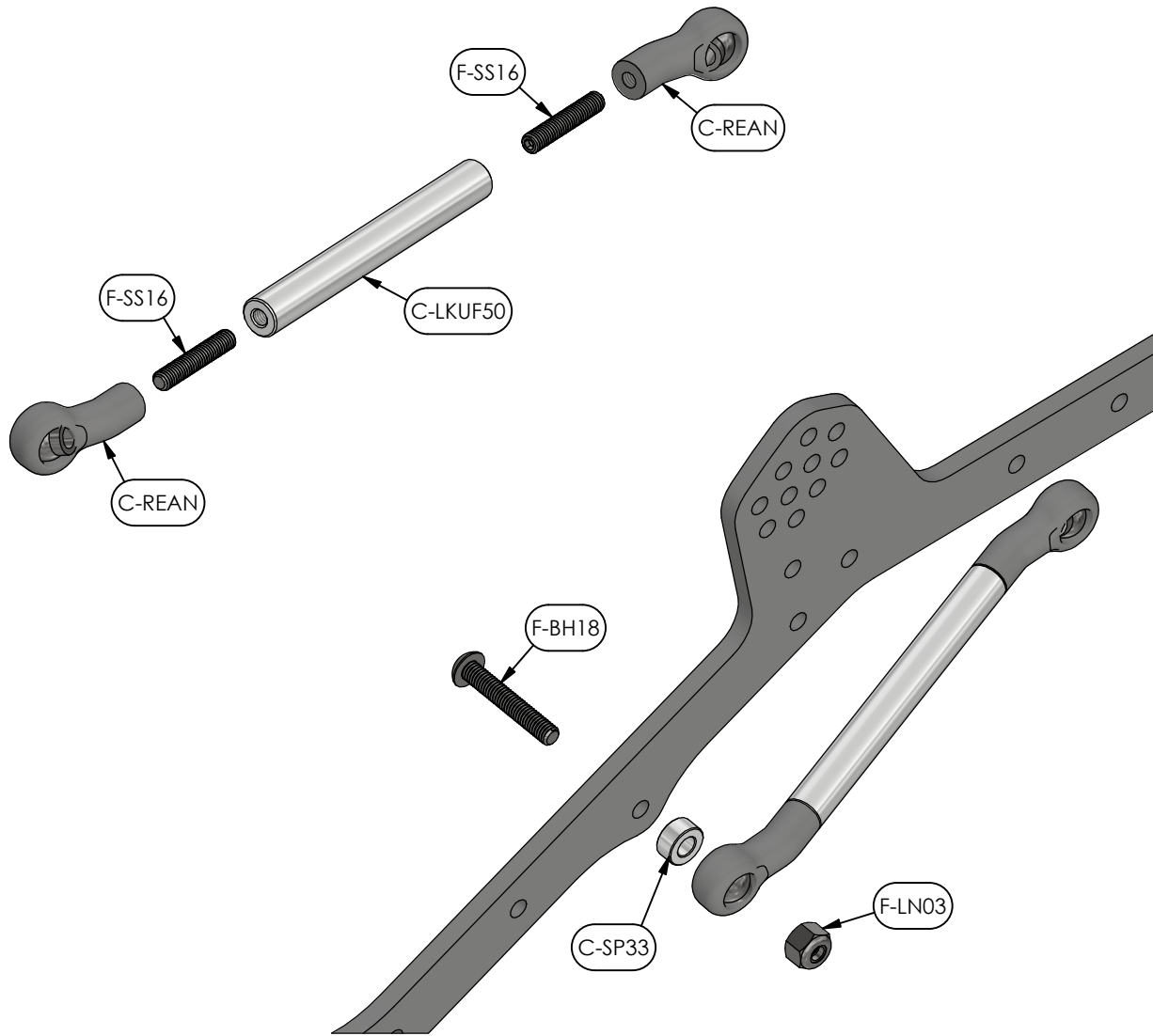

F-BH16 - (2)  
M3x16mm Button Head

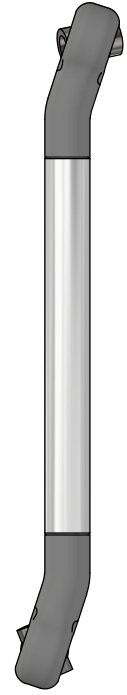

**INSTALL ON OUTSIDE  
OF RIGHT CHASSIS RAIL**



**ROD END ORIENTATION**

-  F-SS16 - (2)  
M3x16mm Set Screw
-  C-SP33 - (1)  
3x3 Spacer
-  F-BH18 - (1)  
M3x18mm Button Head
-  F-LN03 - (1)  
3mm Locknut

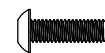
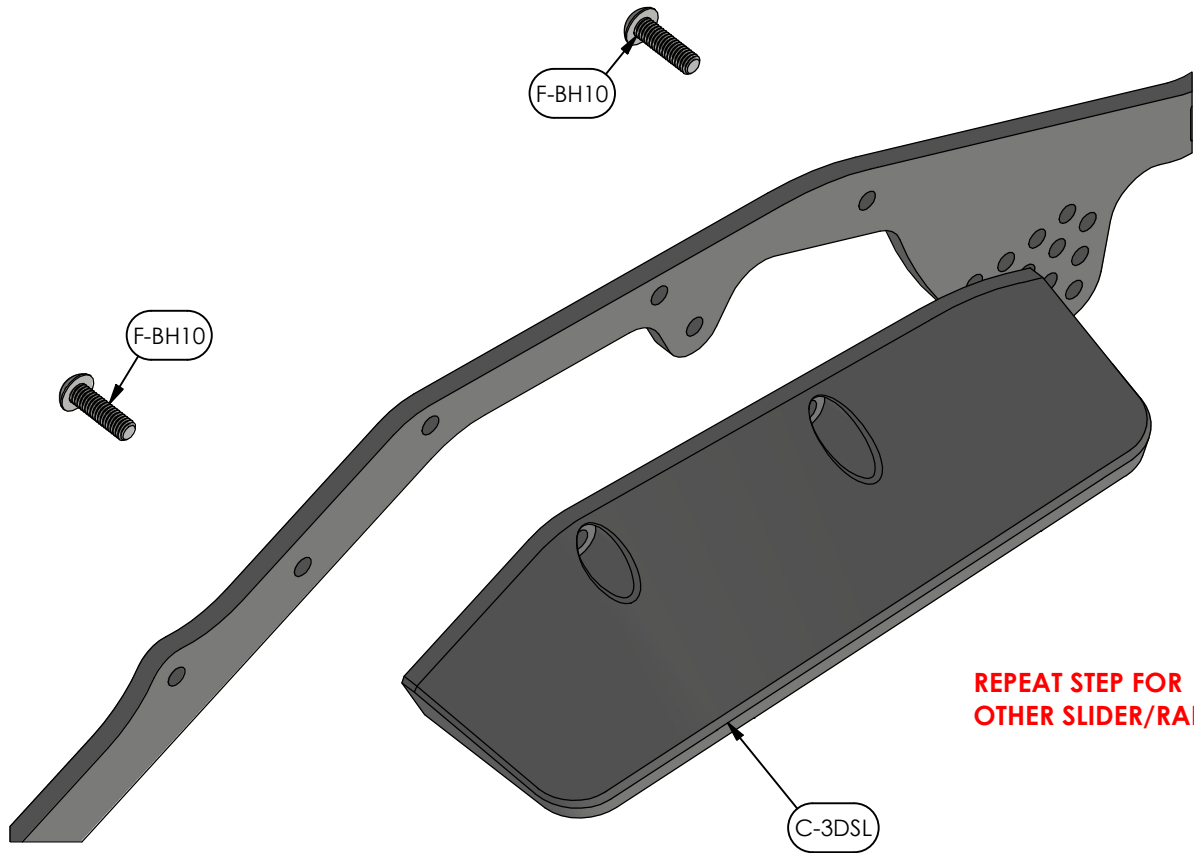

F-BH10 - (4)  
M3x10mm Button Head



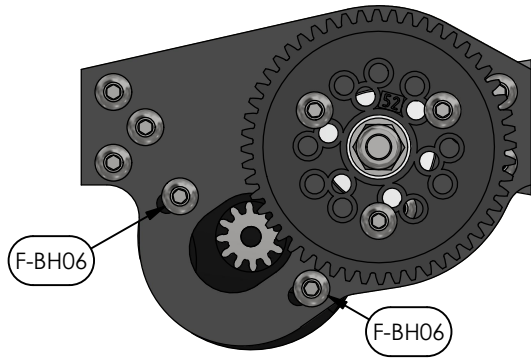

**INSTALL MOTOR AND SET GEAR MESH  
PRIOR TO INSTALLING PRIMARY DRIVE  
INTO CHASSIS. USE 12T-17T PINION  
WITH 52T SPUR**

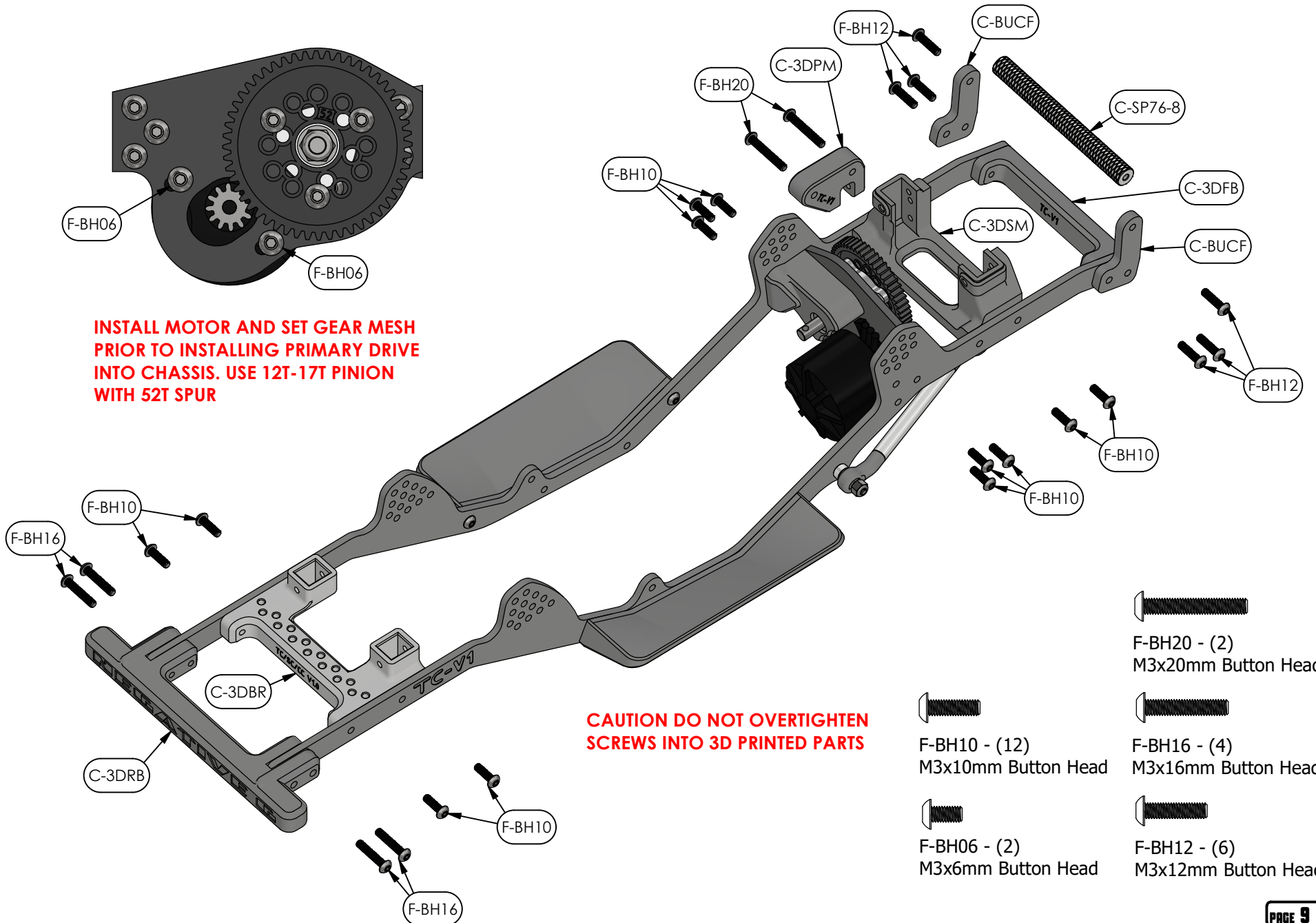

**CAUTION DO NOT OVERTIGHTEN  
SCREWS INTO 3D PRINTED PARTS**

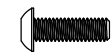

F-BH10 - (12)  
M3x10mm Button Head



F-BH06 - (2)  
M3x6mm Button Head



F-BH20 - (2)  
M3x20mm Button Head



F-BH16 - (4)  
M3x16mm Button Head



F-BH12 - (6)  
M3x12mm Button Head



C-SP76-8

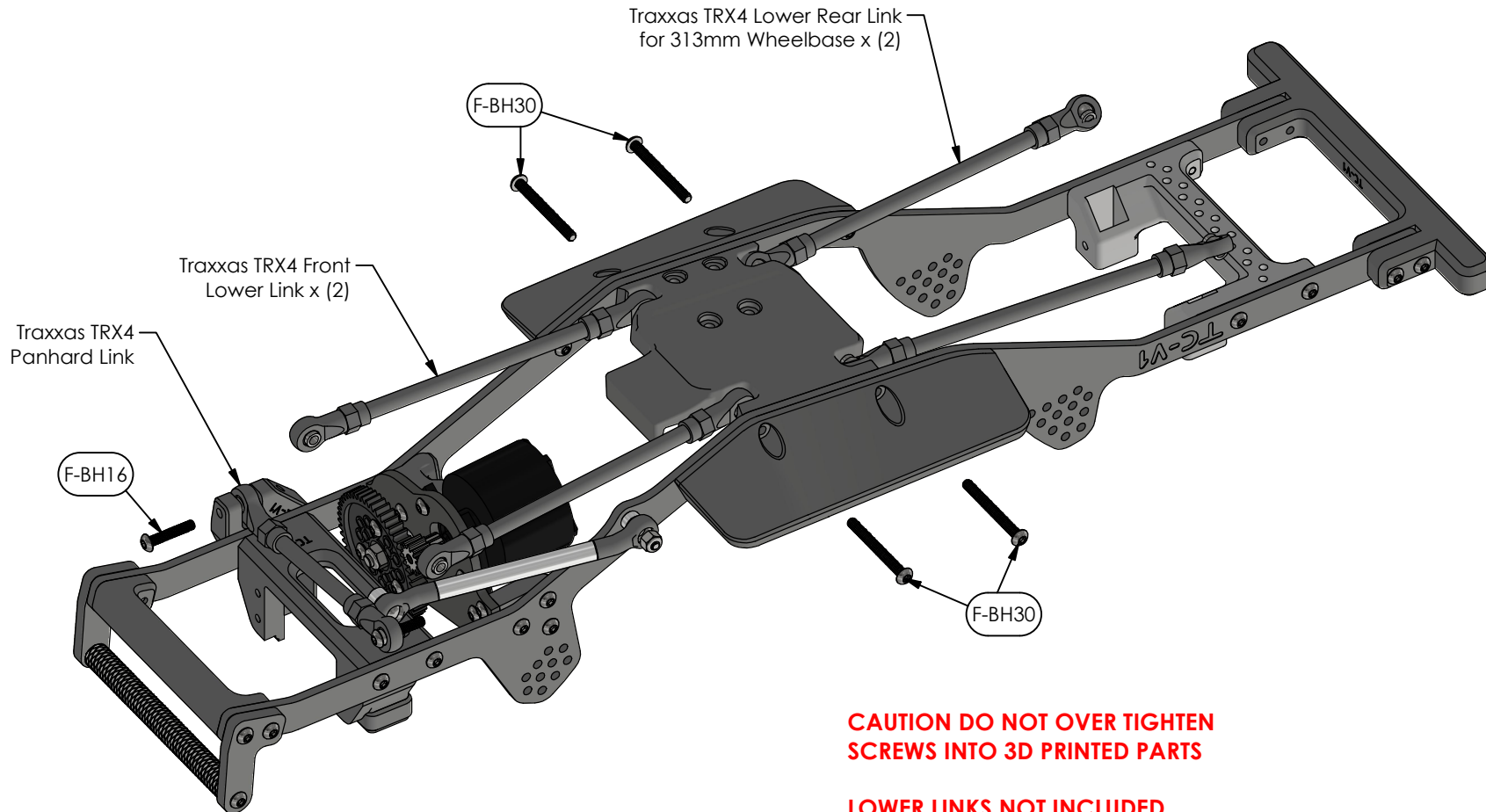

**CAUTION DO NOT OVER TIGHTEN  
SCREWS INTO 3D PRINTED PARTS**

**LOWER LINKS NOT INCLUDED**

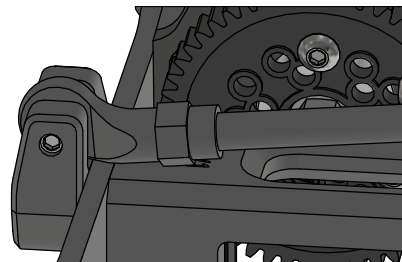

**ROD END ORIENTATION**



F-BH30 - (4)  
M3x30mm Button Head



F-BH16 - (1)  
M3x16mm Button Head

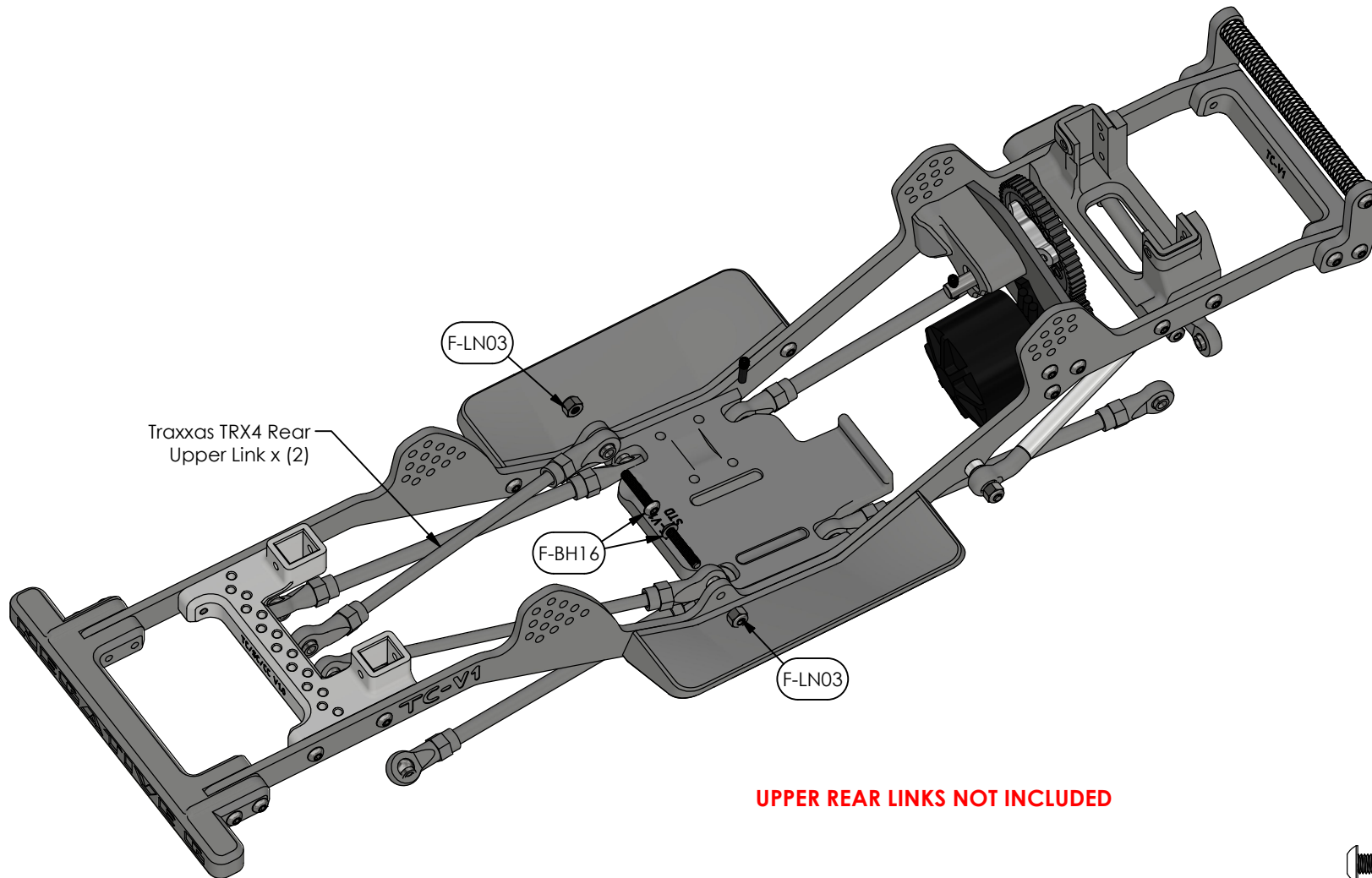

**UPPER REAR LINKS NOT INCLUDED**



F-BH16 - (2)  
M3x16mm Button Head



F-LN03 - (2)  
3mm Locknut



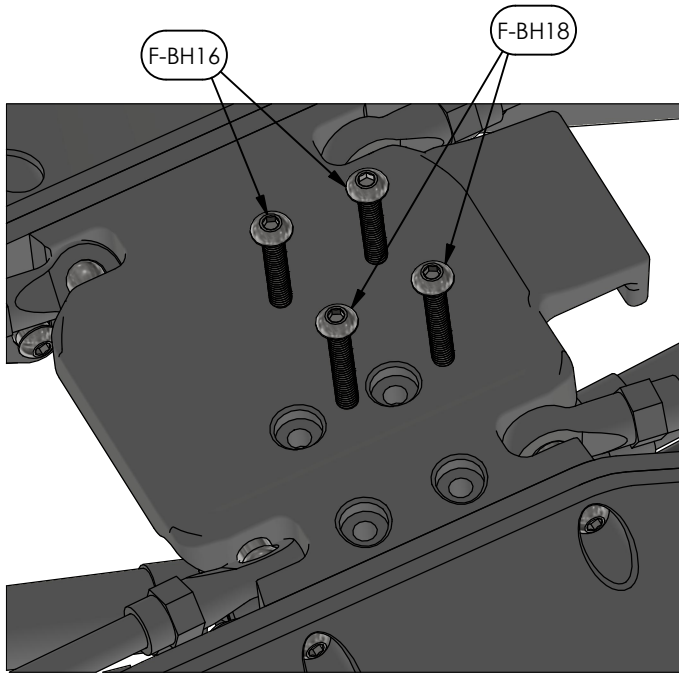

**CAUTION DO NOT OVERTIGHTEN  
SCREWS INTO 3D PRINTED PARTS**

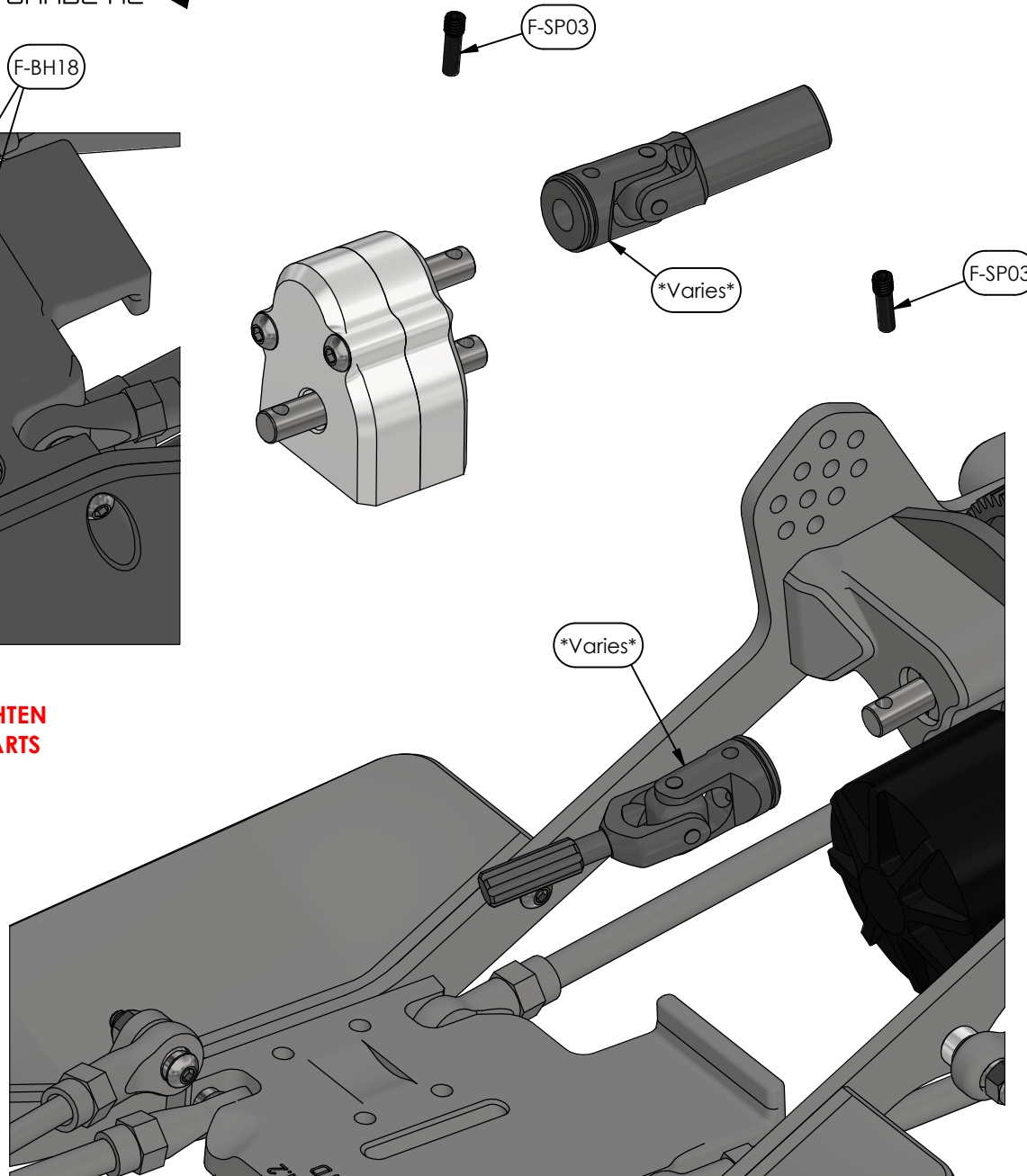

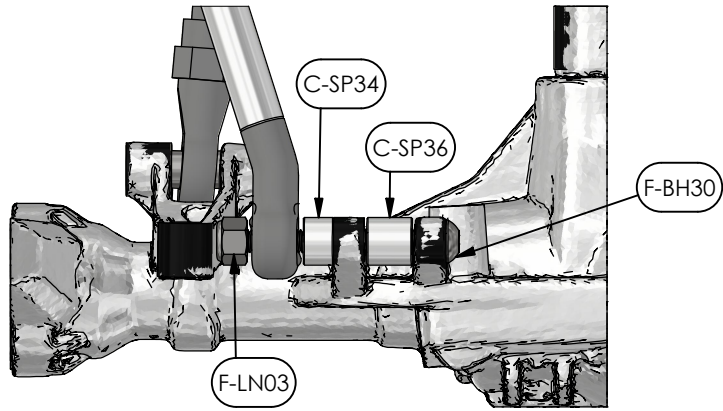

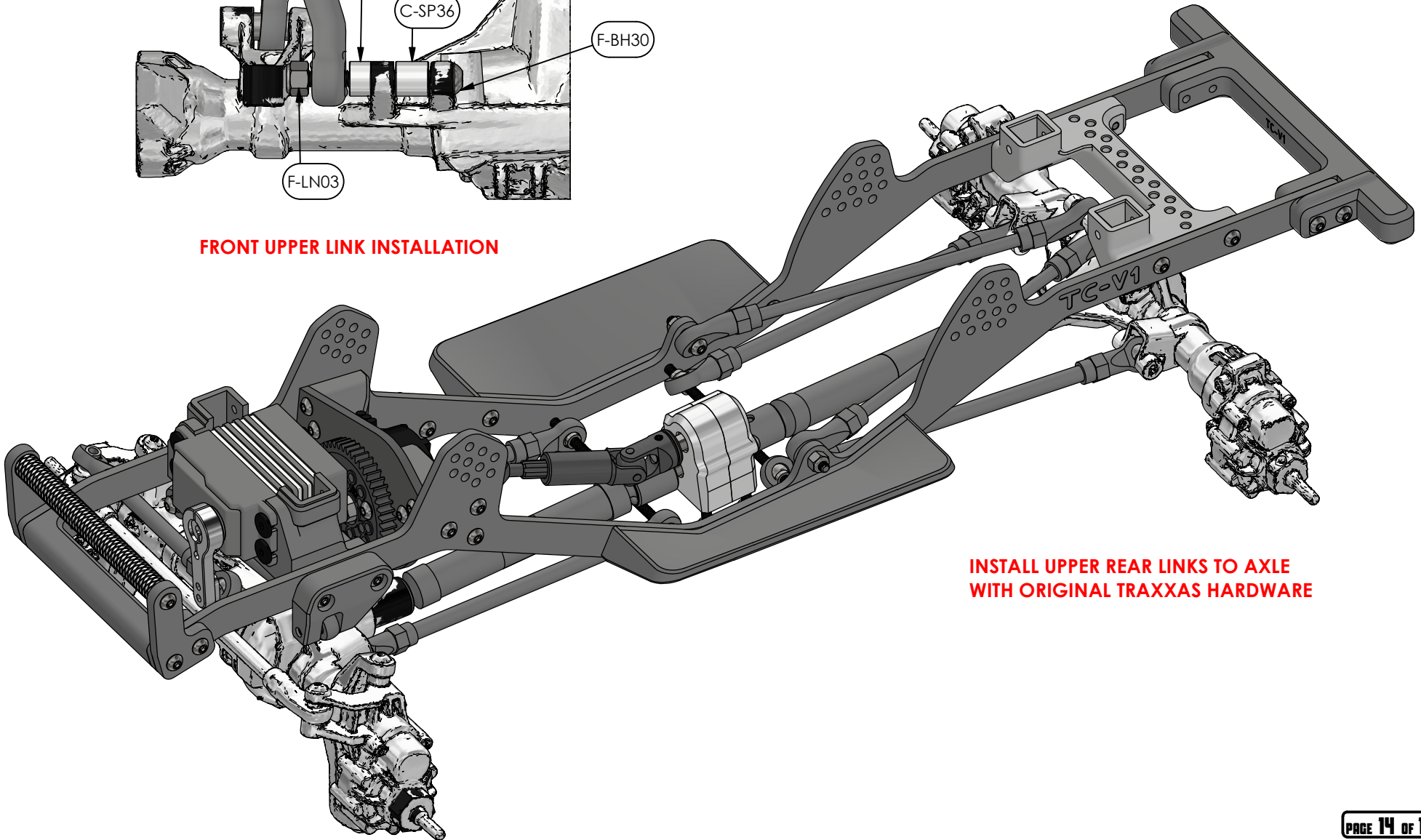

## FRONT UPPER LINK INSTALLATION

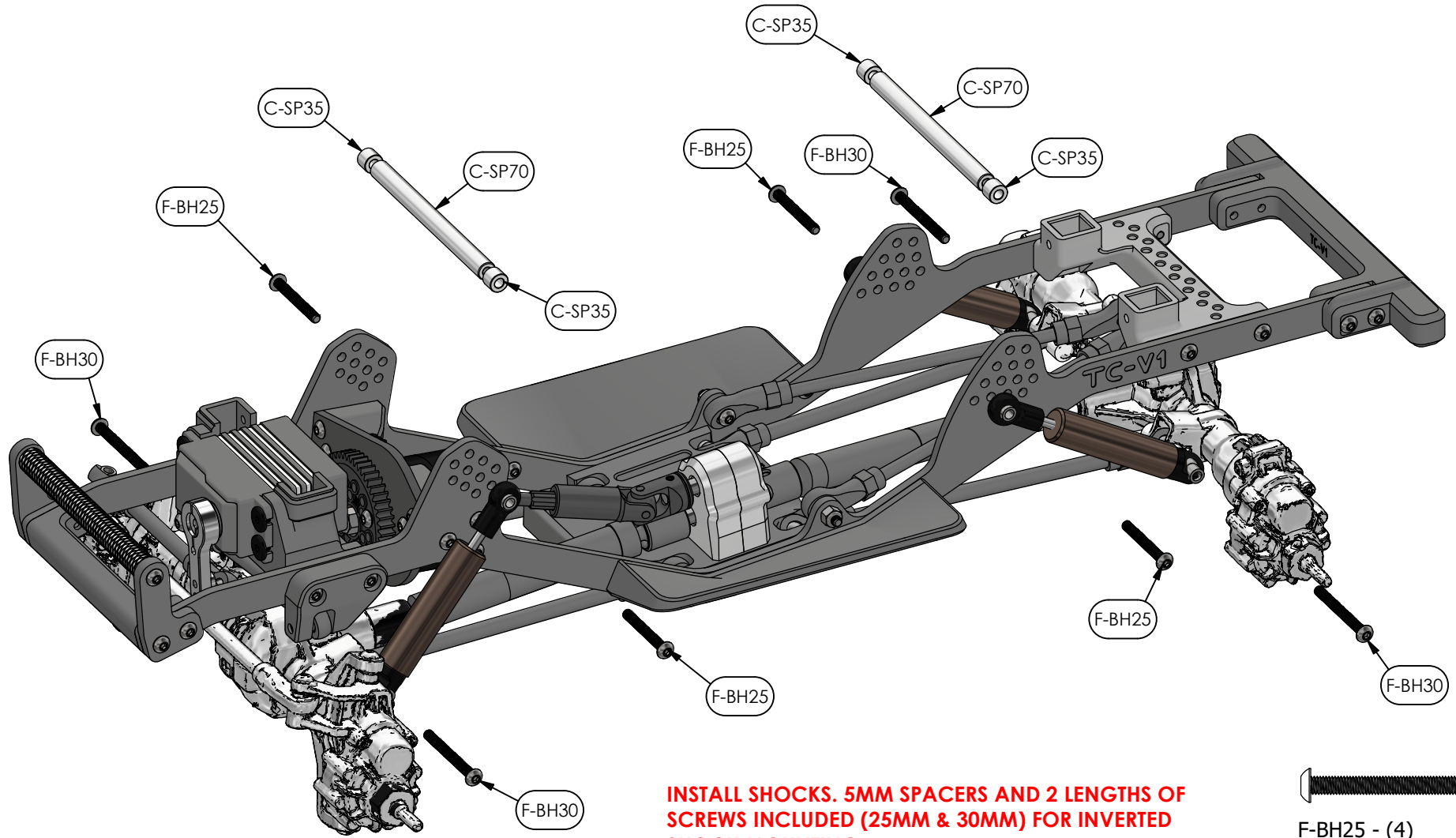

**INSTALL UPPER REAR LINKS TO AXLE  
WITH ORIGINAL TRAXXAS HARDWARE**



**INSTALL SHOCKS. 5MM SPACERS AND 2 LENGTHS OF SCREWS INCLUDED (25MM & 30MM) FOR INVERTED SHOCK MOUNTING**

  
 C-SP35 - (4)  
 3x5 Spacer

  
 F-BH25 - (4)  
 M3x25mm Button Head

  
 F-BH30 - (4)  
 M3x30mm Button Head

**PLACE SMALL ROUND STICKERS ON CHASSIS RAILS.  
INSTALL WHEEL/TIRE PACKAGE. REQUIRED BUT NOT  
INCLUDED: TRAXXAS TRA8115 BODY MOUNTS AND  
BODY MOUNT SCREW PINS**

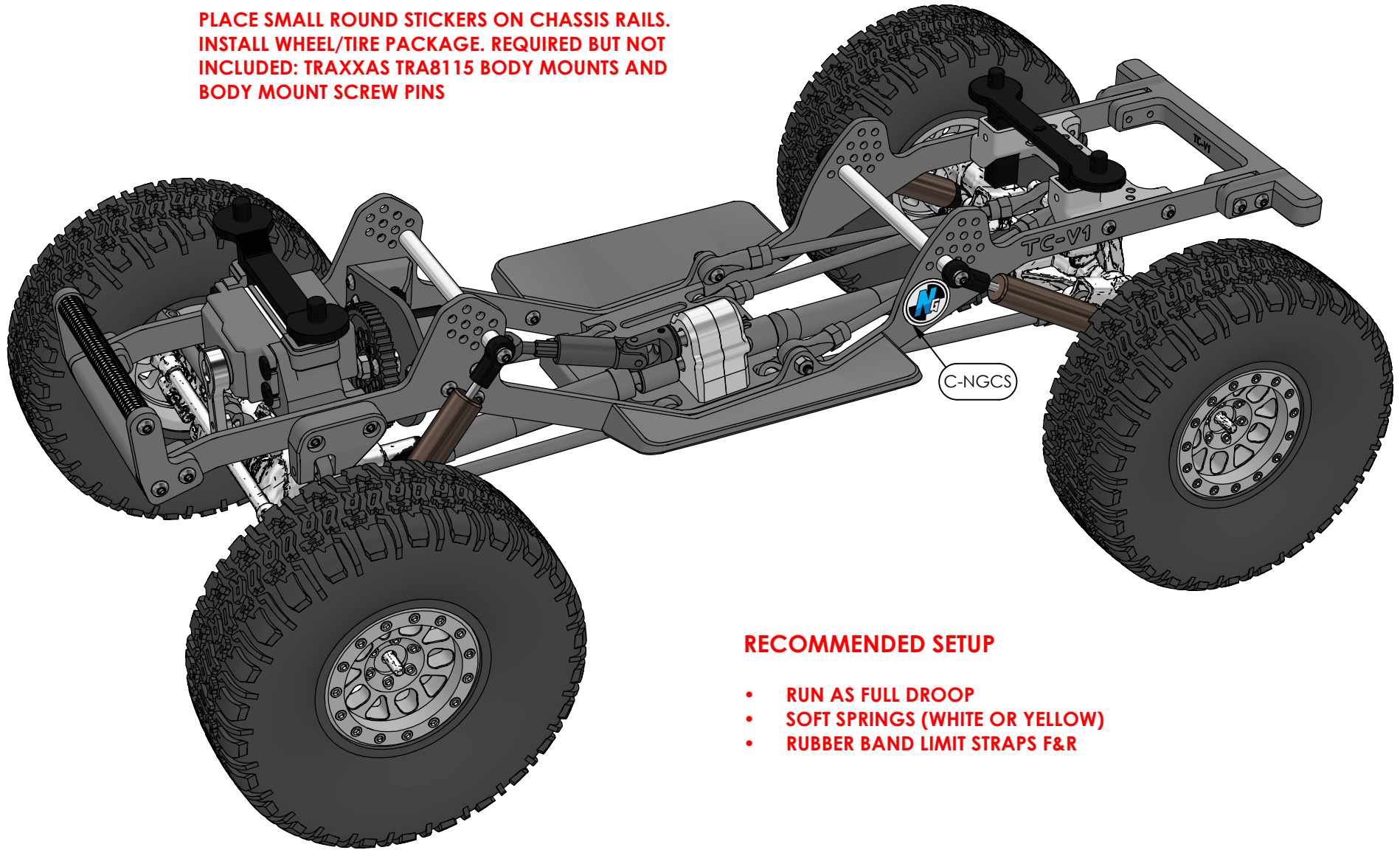

## RECOMMENDED SETUP

- RUN AS FULL DROOP
- SOFT SPRINGS (WHITE OR YELLOW)
- RUBBER BAND LIMIT STRAPS F&R



**OPTIONAL PARTS**

**CHECK <http://www.negativegrc.com> FOR AVAILABILITY AND PRICING**

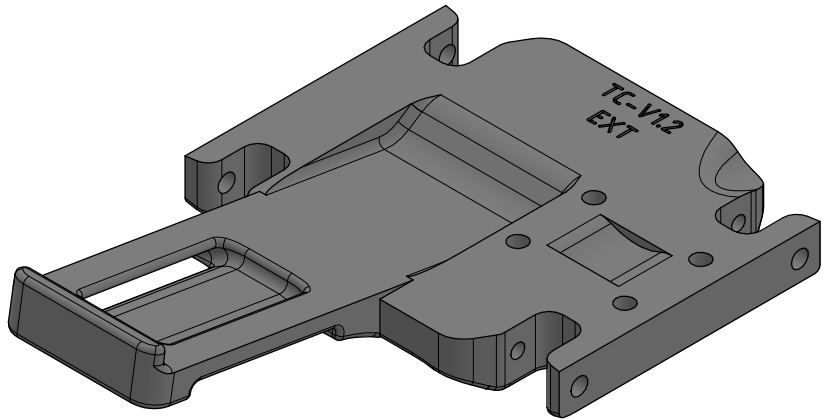

C-3DSL  
Center Skid - Extended

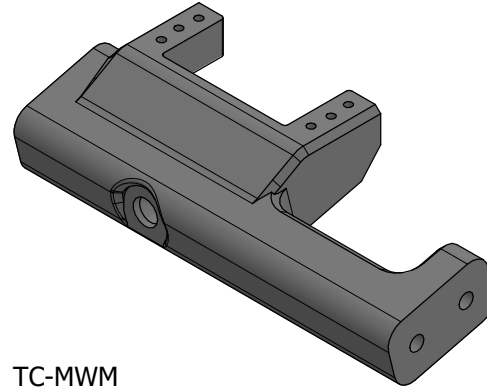

TC-MWM  
MICRO WINCH BUMPER

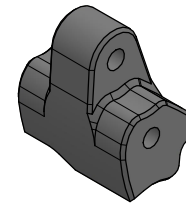

Rear Link Riser 10mm v2  
TC-V1 10mm Link Riser Rear

**DON'T LET GRAVITY WIN!**