



This **LCG Class 2 chassis system** is designed specifically for the **313mm/12.3"** wheelbase **Capra platform**.

Kit features:

- ***NEW*** All plastic parts are printed with **ultra lightweight high-tech polymer PA12 Nylon** using **SLS technology**
- Divorced primary drive with a compact and lightweight **Generation 2** transfer case
- Stainless Steel primary drive and transfer case shafts
- Stainless Steel screws, nuts and miscellaneous hardware
- Genuine **Vanquish Incision** 52t 32p spur gear included
- Excellent weight distribution, low center of gravity
- Improved suspension geometry with built in anti squat and a low instant center
- Steel prop shaft with brass pivot balls
- Your choice of 2 skid plates: Standard for 540/550 motors and Extended for shorter outrunner style motors up to 40mm in length
- 3mm Carbon Fiber matte twill weave frame rails with integrated shock mounts
- 3mm Carbon Fiber matte twill weave motor mount plate
- Lay down servo mount
- 12.3" approximate wheelbase
- For optimum performance a **full droop setup front and rear is recommended**. Just add your axles, links, driveshafts, shocks and electronics package and hit the rocks!

Required parts not included:

- Capra Axles, suspensions links, drive shafts and shocks
- Traxxas 3931 3x8 flanged screws or equivalent
- Traxxas 8115 body mount kit
- Electronics package
- Wheels/tires
- Body

! CAUTION !

DO NOT OVERTIGHTEN SCREWS INTO 3D PRINTED PARTS. POWERED SCREWDRIVERS GENERATE HEAT WHEN INSTALLING SCREWS. IF YOU ARE USING A POWERED SCREWDRIVER, INSTALL TO 75% DEPTH AND LET THE PLASTIC COOL OFF. HAND TIGHTEN TO 100%.

STRIPPED HOLES ARE NOT COVERED UNDER WARRANTY!

Please read this entire instruction book prior to assembly



F-BH30 - (4)
M3x30mm Button Head



F-BH25 - (6)
M3x25mm Button Head



F-BH20 - (4)
M3x20mm Button Head



F-BH18 - (3)
M3x18mm Button Head



F-BH16 - (3)
M3x16mm Button Head



F-BH12 - (11)
M3x12mm Button Head



F-BH10 - (25)
M3x10mm Button Head



F-BH08 - (3)
M3x8mm Button Head



F-BH06 - (5)
M3x6mm Button Head



F-SS20 - (4)
M4x20 Set Screw

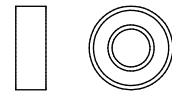

D-B5114 - (5)
5x11x4 Bearing



D-B5104-F - (1)
5x10x4 Bearing Flanged



D-B4104-F - (1)
4x10x4 Bearing Flanged



D-DP10 - (2)
2.5mm x 10mm Dowel Pin



F-EC04 - (3)
4mm E Clip



F-FW04 - (1)
4mm Flat Washer



F-LN03 - (3)
3mm Locknut



F-LN04 - (1)
M4mm Lock Nut

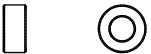

C-SP33 - (1)
3x3 Spacer



C-SP35 - (4)
3x5 Spacer



D-SP55 - (1)
5x5 Spacer



D-TCTG - (1)
Transfer Case Top Gear

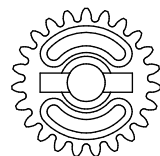

D-TCBG - (1)
Transfer Case Bottom Gear

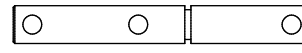

D-TCBS - (1)
Transfer Case Bottom Shaft

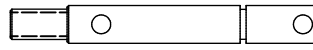

D-TS - (1)
Transmission Shaft

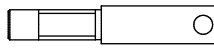

D-TCTS - (1)
Transfer Case Top Shaft

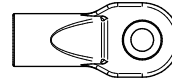

C-RRES - (4)
4mm Rod End

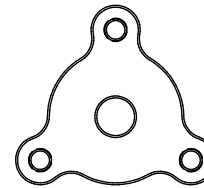

D-NGSA - (1)
Spur Adapter v2



C-SP70 - (2)
M3x70mm Chassis Spacer



C-LKDP - (2)
M4x50mm Drag/Panhard Link

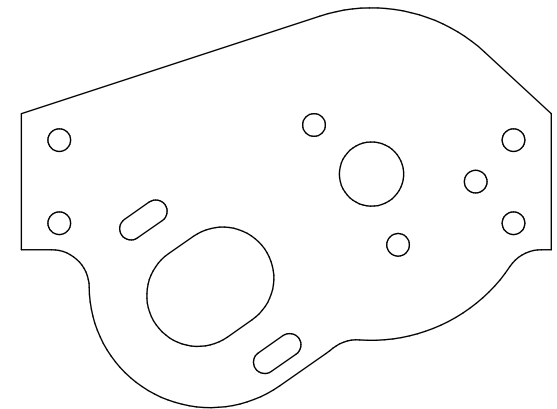

SC-D-PDMP - (1)
SC Carbon Motor Plate

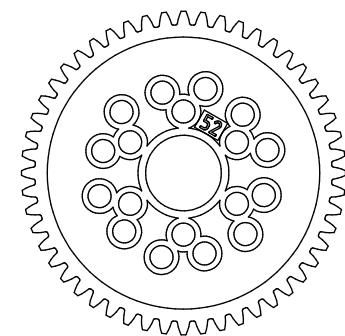

D-SG52 - (1)
Incision 52t Spur

PART # TO RAIL

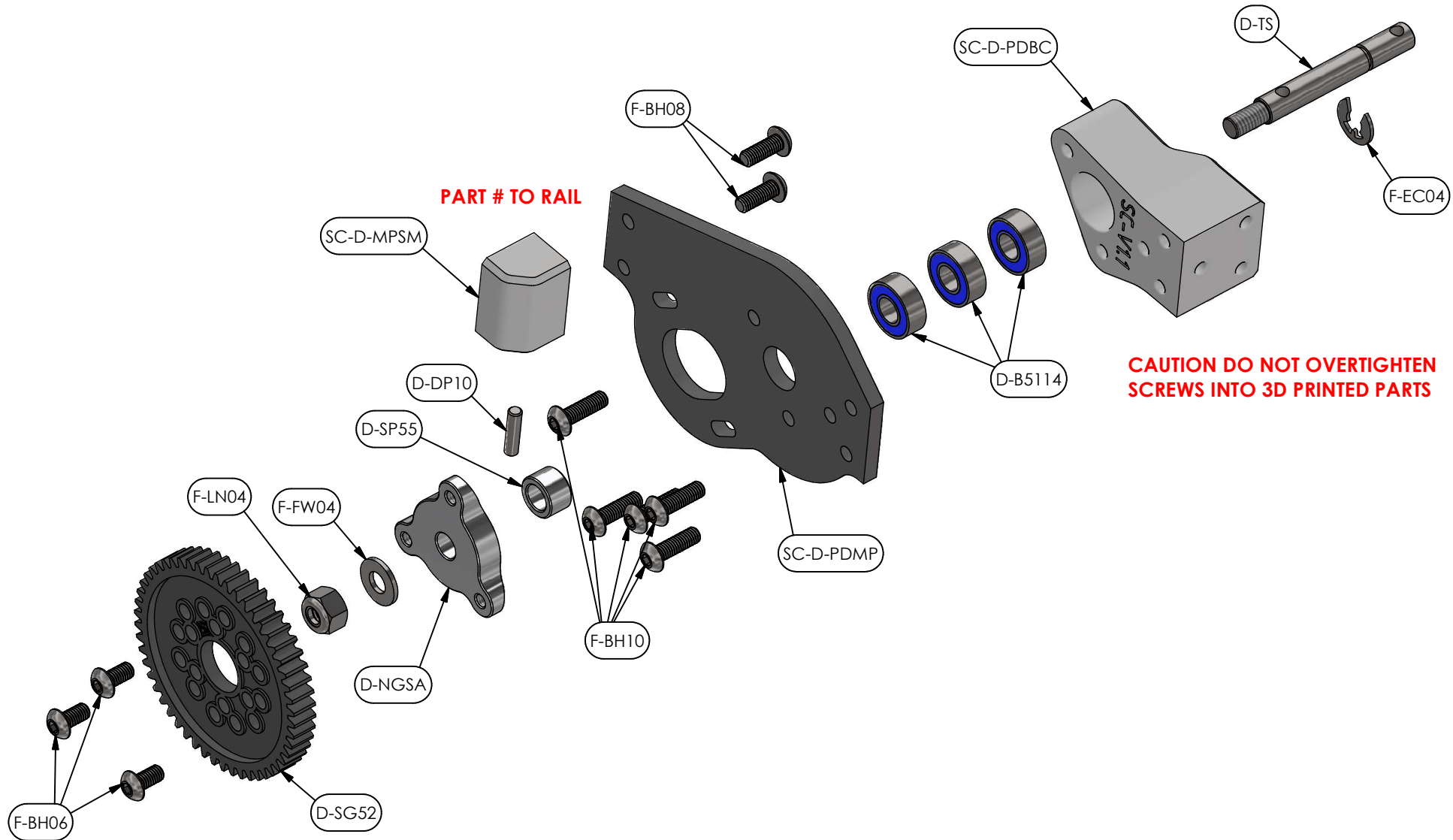

CAUTION DO NOT OVERTIGHTEN SCREWS INTO 3D PRINTED PARTS

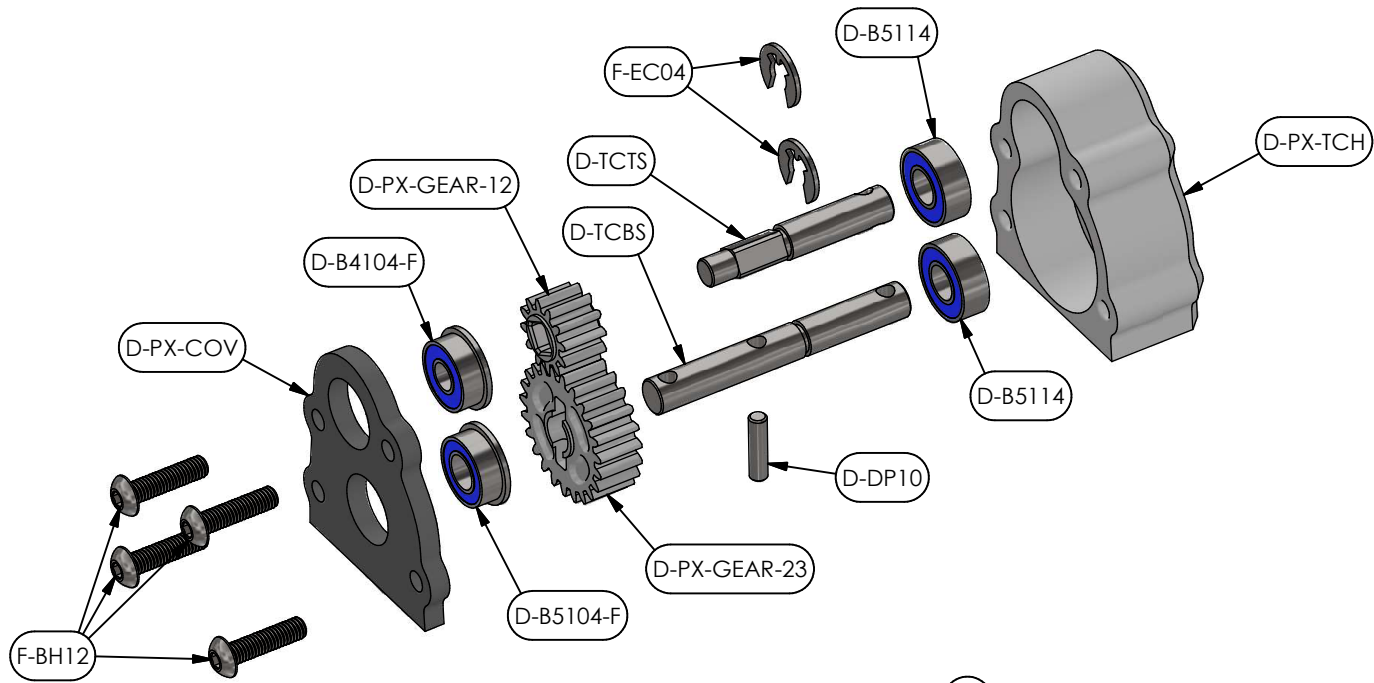

**CAUTION DO NOT OVERTIGHTEN
SCREWS INTO 3D PRINTED PARTS**

MINIMAL GREASE REQUIRED

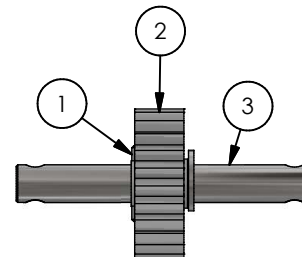

BOTTOM SHAFT ASSEMBLY ORDER:

1. CROSS PIN
2. GEAR
3. E-CLIP

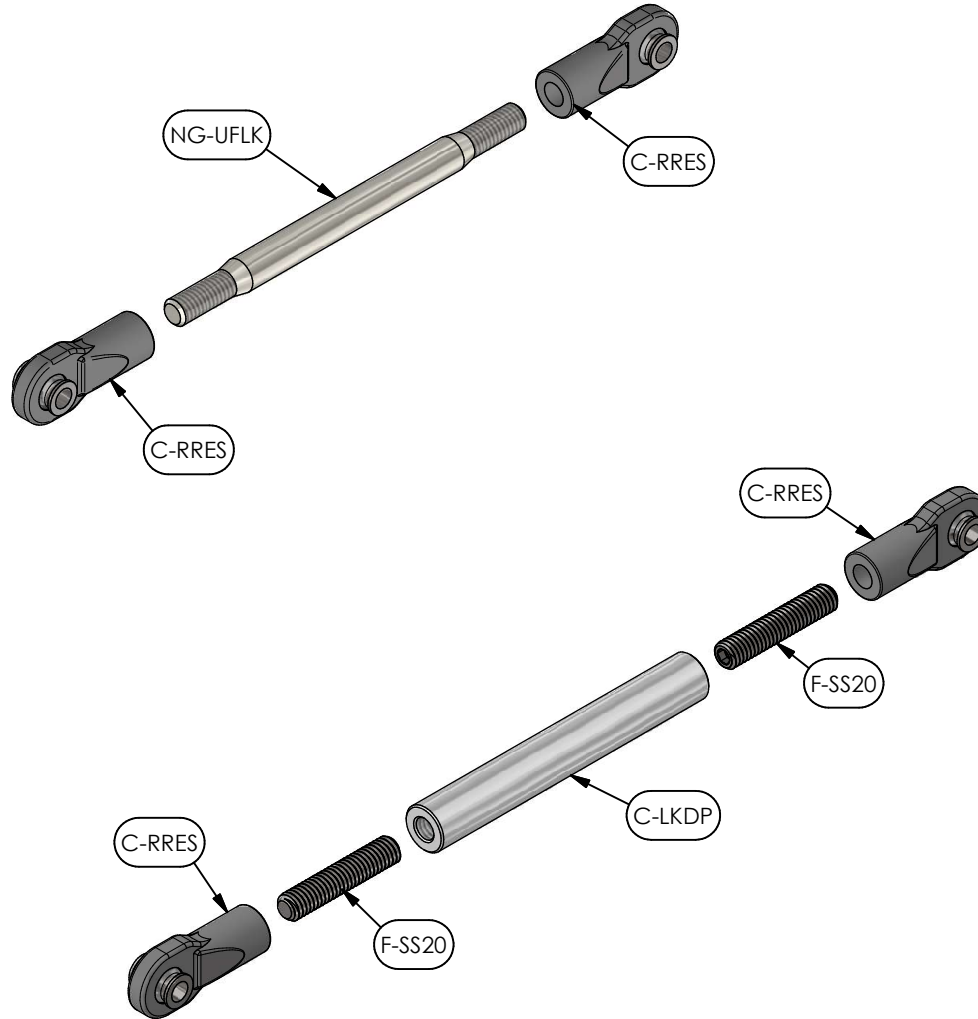
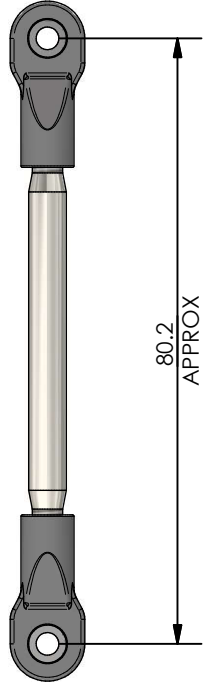

**NOTE CLOCK ONE
END 90° FOR DRAG LINK**

Panhard Link/Drag Link - Qty (2)

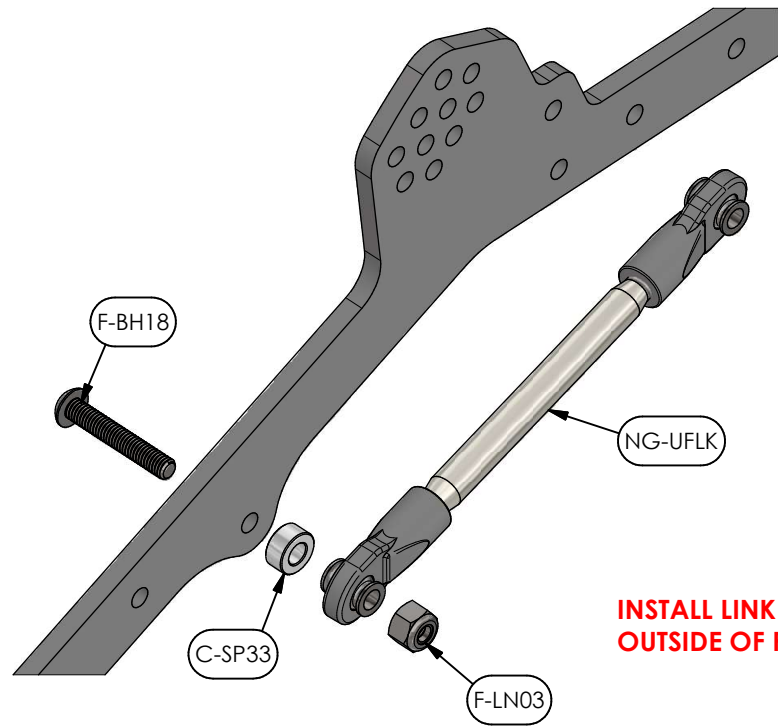

**INSTALL LINK ON
OUTSIDE OF RAIL**

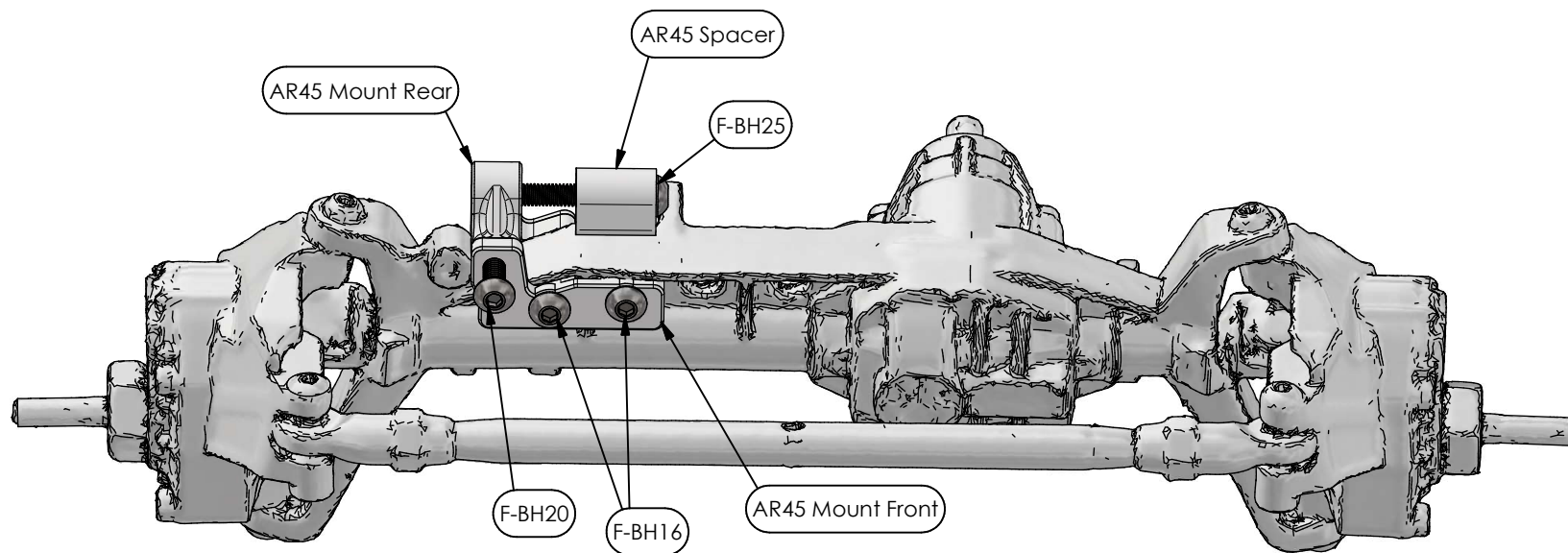

**CAUTION DO NOT OVER TIGHTEN
SCREWS INTO 3D PRINTED PARTS**

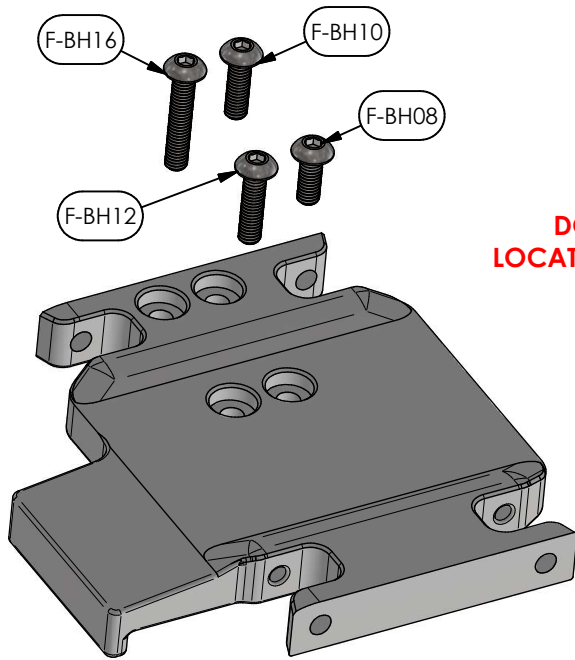

**!!IMPORTANT STEP!
DOUBLE CHECK SCREW LENGTH AND
LOCATION WHEN INSTALLING TRANSFER CASE**

**CAUTION DO NOT OVER TIGHTEN
SCREWS INTO 3D PRINTED PARTS**

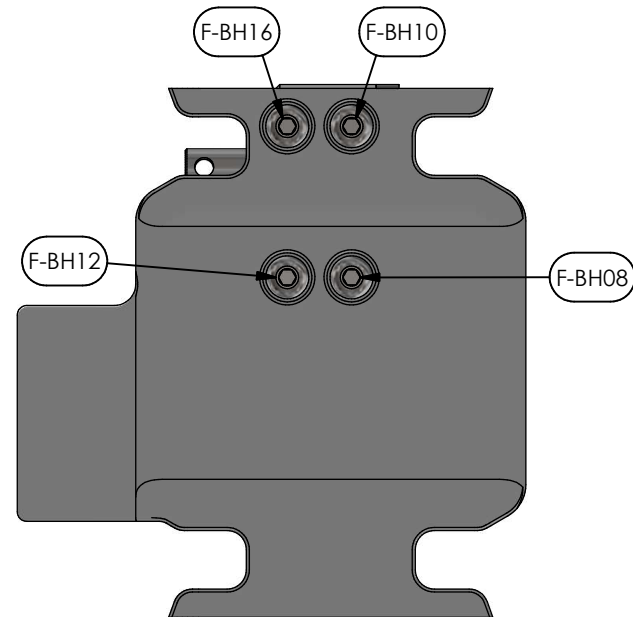

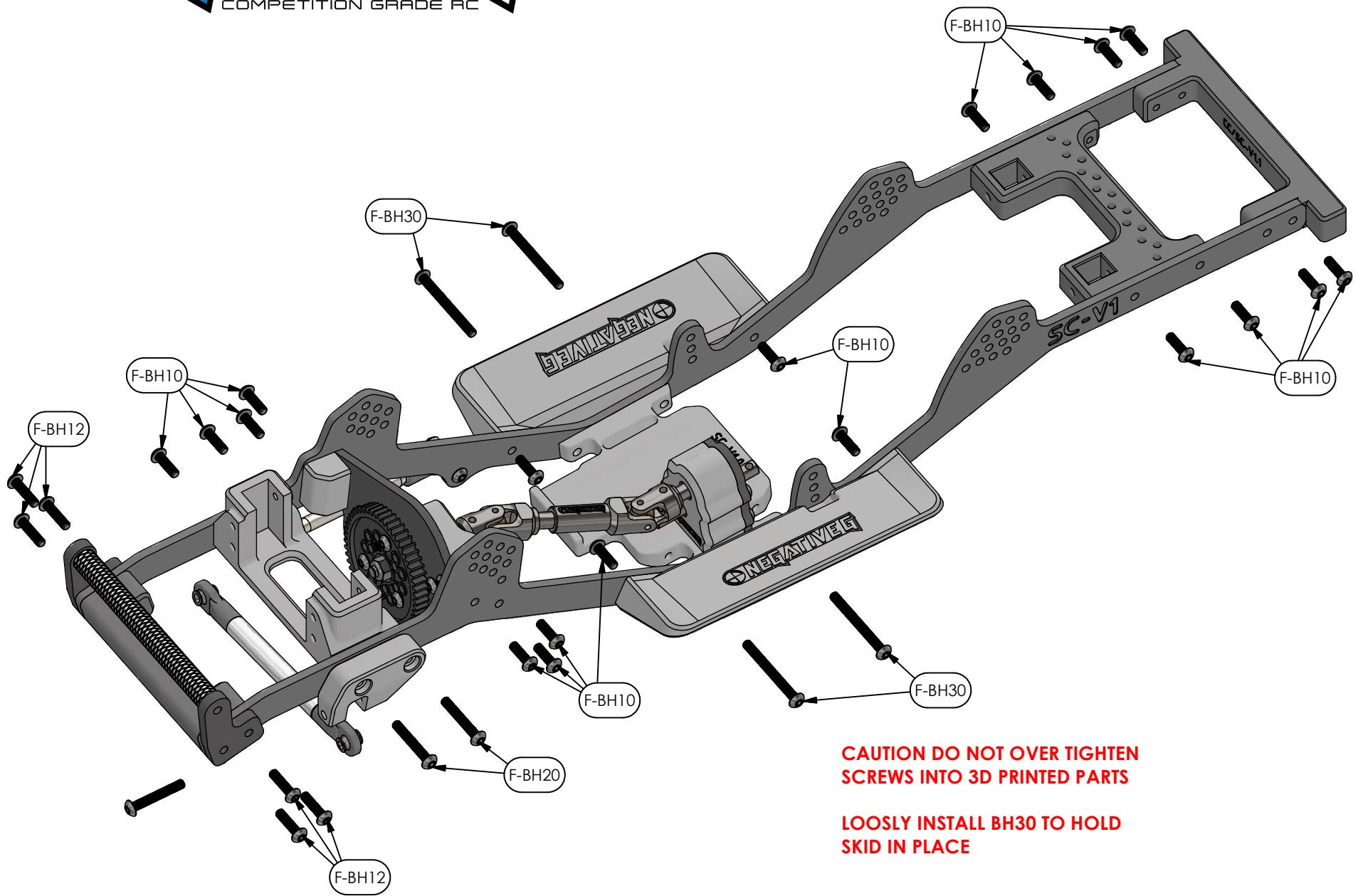

**CAUTION DO NOT OVER TIGHTEN
SCREWS INTO 3D PRINTED PARTS**

**LOOSLY INSTALL BH30 TO HOLD
SKID IN PLACE**

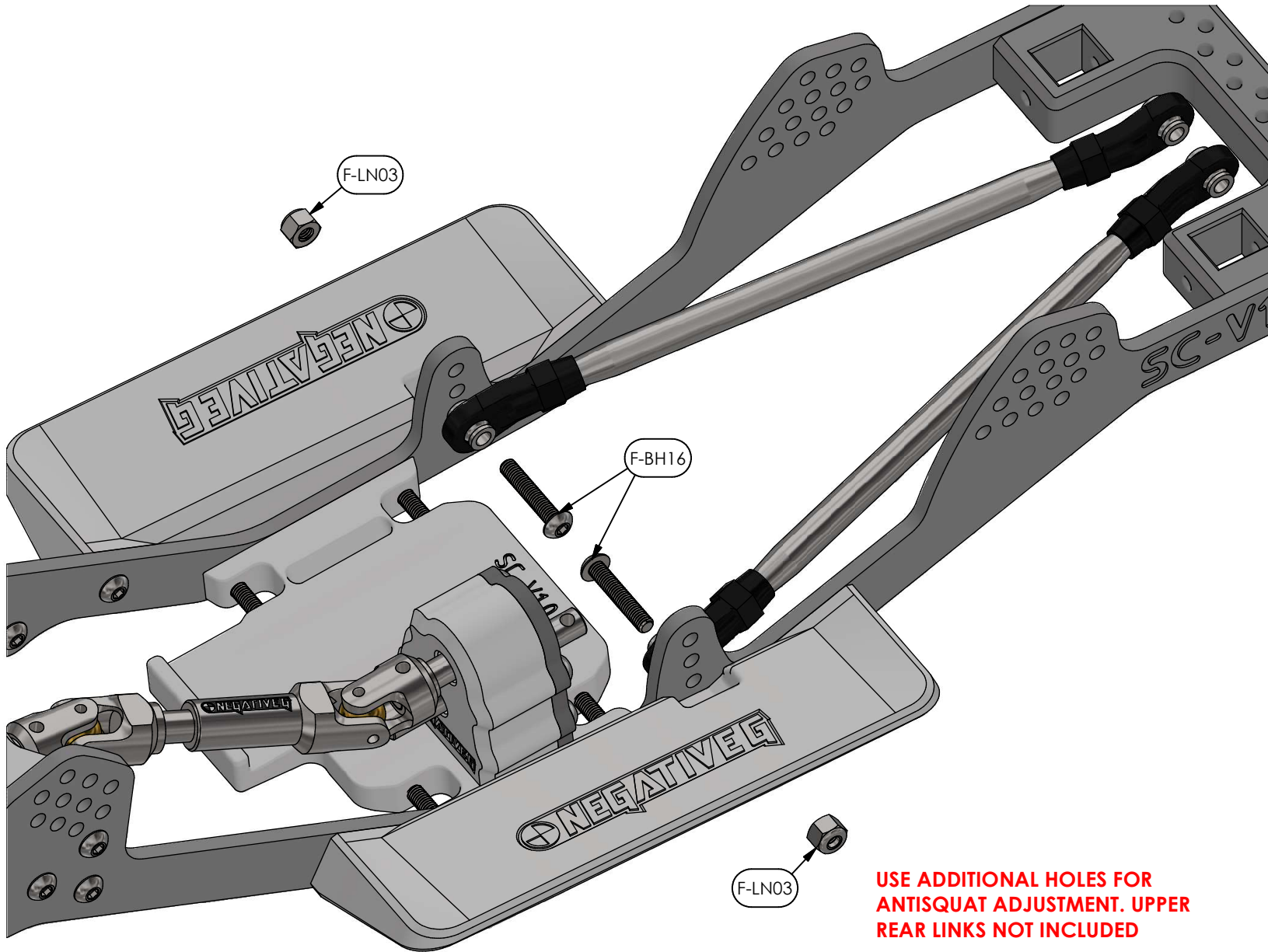

**USE ADDITIONAL HOLES FOR
ANTISQUAT ADJUSTMENT. UPPER
REAR LINKS NOT INCLUDED**

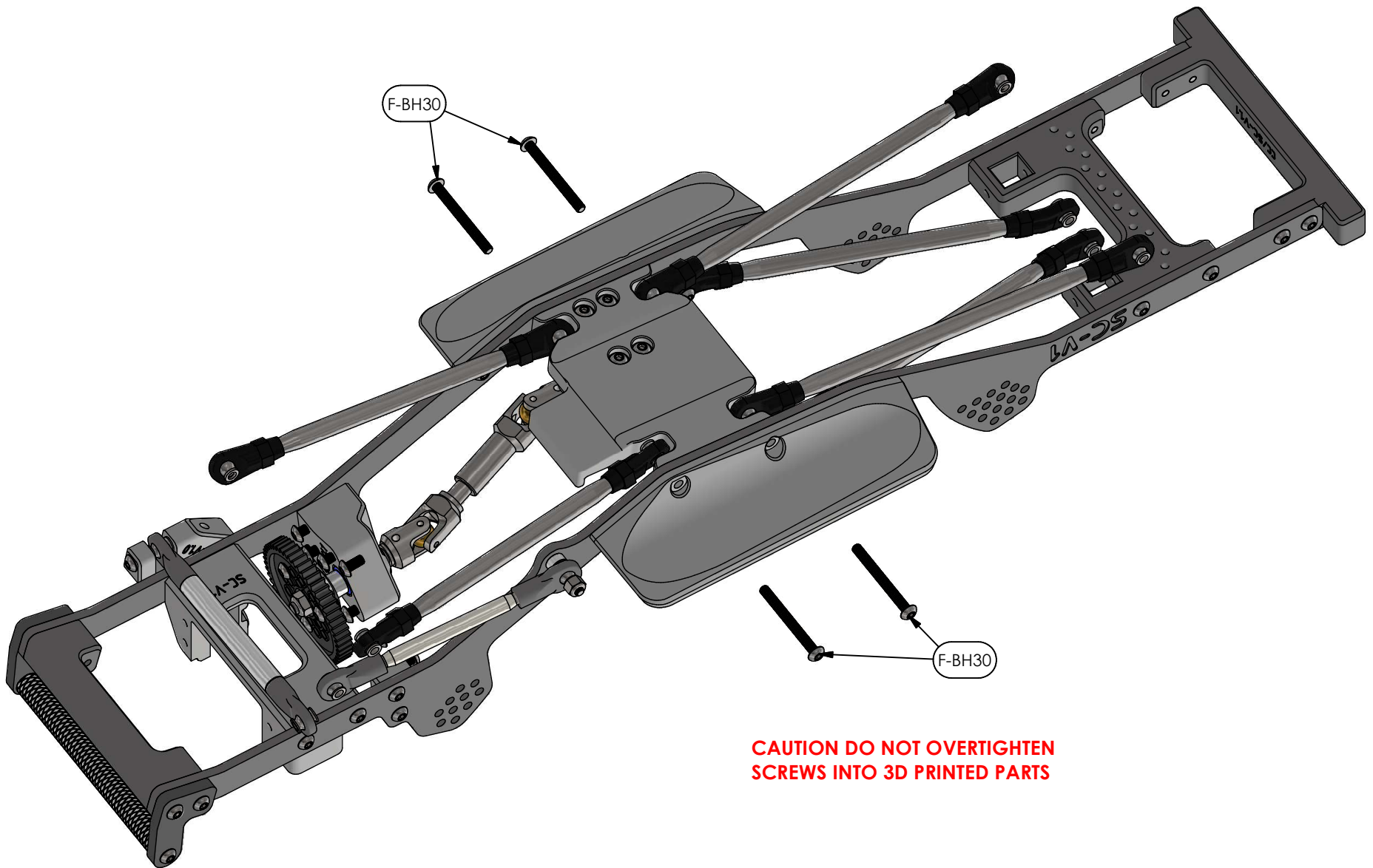

**CAUTION DO NOT OVERTIGHTEN
SCREWS INTO 3D PRINTED PARTS**

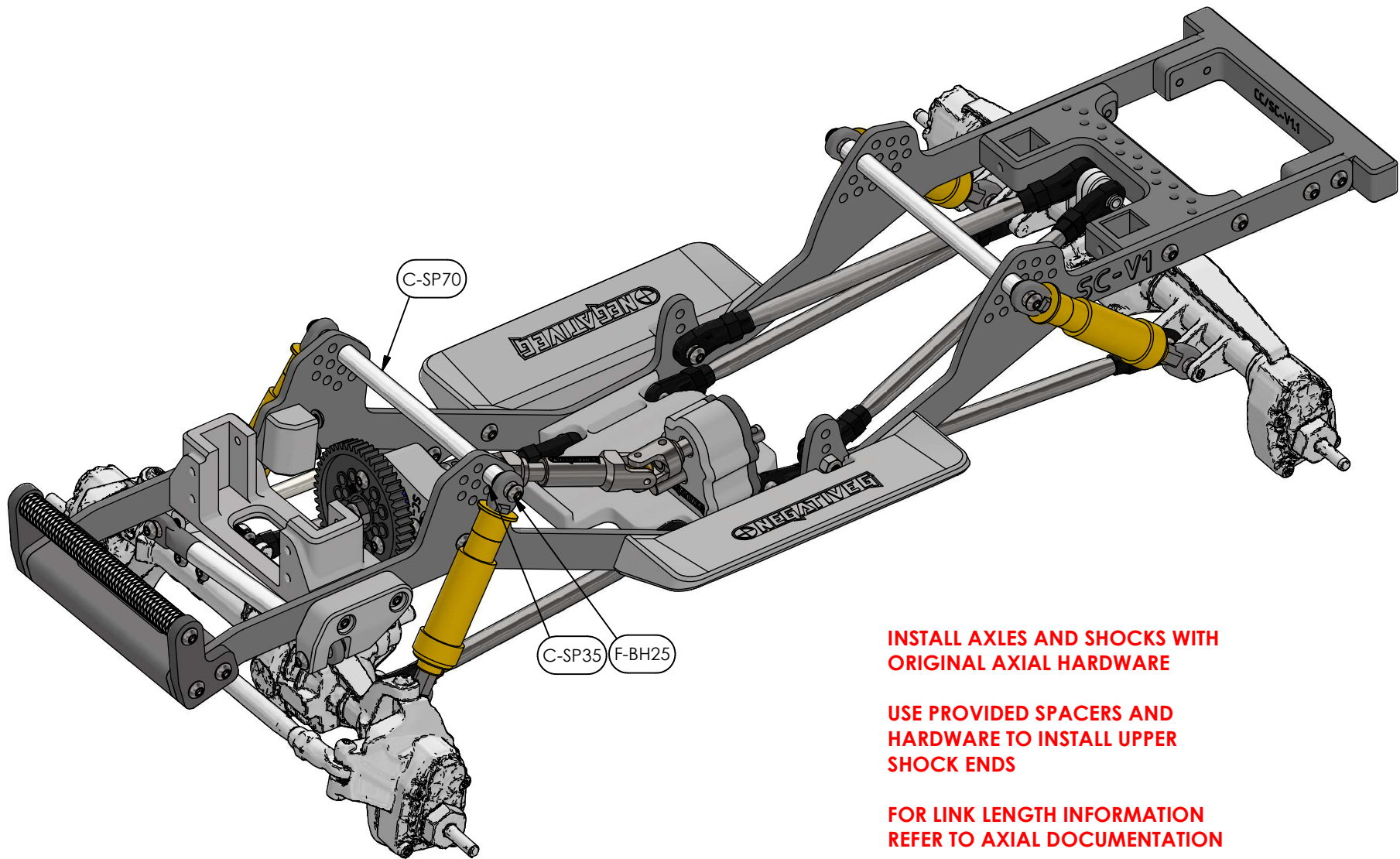

INSTALL AXLES AND SHOCKS WITH ORIGINAL AXIAL HARDWARE

USE PROVIDED SPACERS AND HARDWARE TO INSTALL UPPER SHOCK ENDS

FOR LINK LENGTH INFORMATION REFER TO AXIAL DOCUMENTATION

INSTALL DRIVESHAFTS WITH ORIGINAL AXIAL HARDWARE

INSTALL WHEEL/TIRE PACKAGE. REQUIRED BUT NOT INCLUDED: TRAXXAS TRA8115 BODY MOUNTS AND BODY MOUNT SCREW PINS

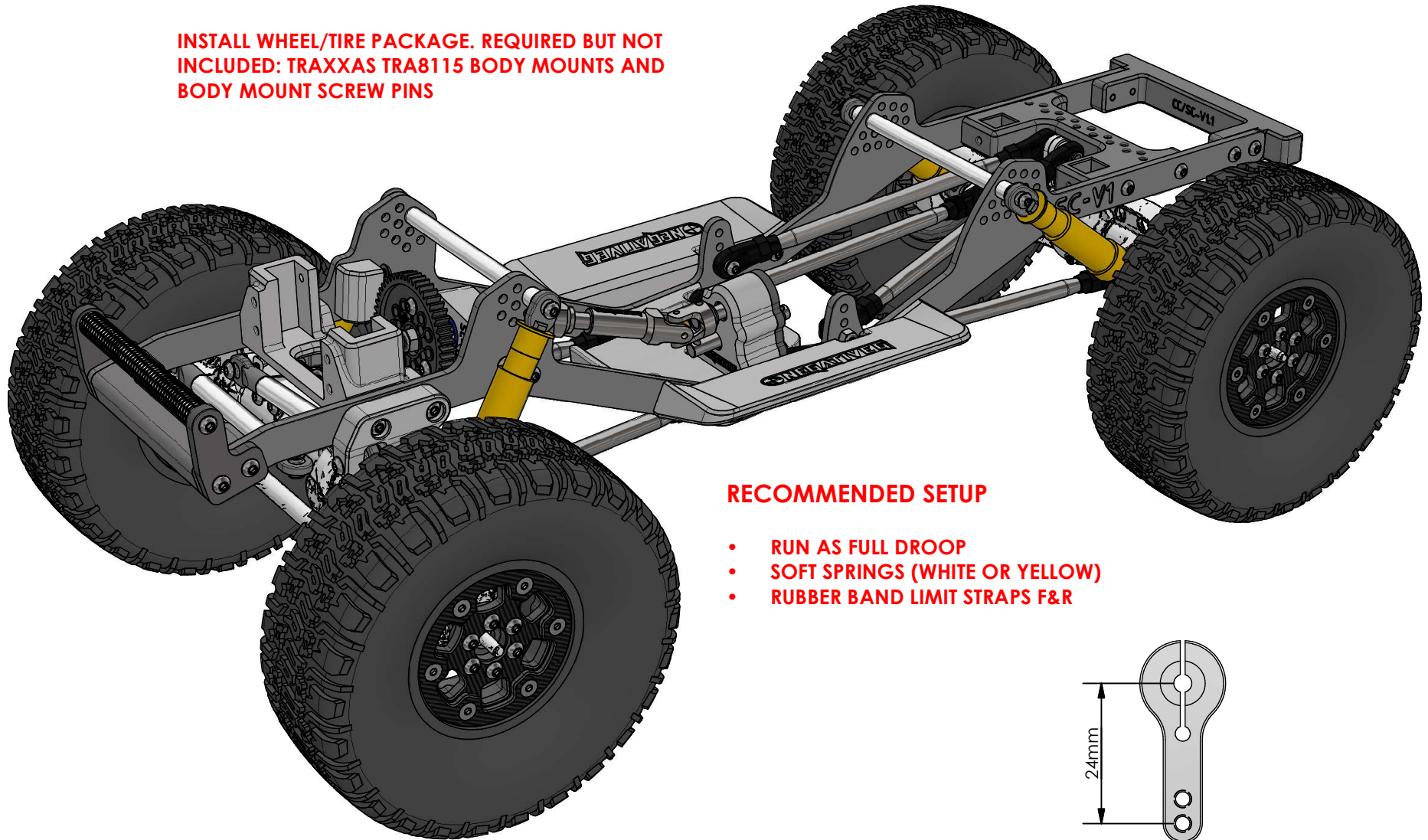

RECOMMENDED SETUP

- RUN AS FULL DROOP
- SOFT SPRINGS (WHITE OR YELLOW)
- RUBBER BAND LIMIT STRAPS F&R

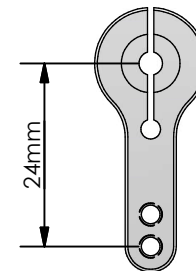

24mm MINIMUM SERVO HORN

INSTALL DRAG LINK TO FRONT SIDE OF HORN