



This all new **LCG Class 1 chassis system** is a universal design for portal axles, preferably Traxxas TRX4 or Axial AR45.

Designed with **state of the art 3D modeling software** to optimize suspension geometry, component location and **center of gravity**.

Kit features:

- Divorced primary drive with a compact and lightweight **Generation 2** transfer case
- Stainless Steel primary drive and transfer case shafts
- Stainless Steel screws, nuts and miscellaneous hardware
- Genuine **Vanquish Incision** 52t 32p spur gear included
- Excellent weight distribution, low center of gravity
- Improved suspension geometry with built in anti squat and a low instant center
- Steel prop shaft with brass pivot balls
- Your choice of 2 skid plates: Standard for 540/550 motors and Extended for shorter outrunner style motors up to 40mm in length
- 3mm Carbon Fiber matte twill weave frame rails with integrated shock mounts
- 3mm Carbon Fiber matte twill weave motor mount plate
- Lay down servo mount
- Included sliders are intended for use with the **RC4WD "Mojave" SWB Hard body**
- 11.4" approximate wheelbase
- For optimum performance a **full droop setup front and rear is recommended**. Just add your axles, links, driveshafts, shocks and electronics package and hit the rocks!

### **! CAUTION !**

**DO NOT OVERTIGHTEN SCREWS INTO 3D PRINTED PARTS. POWERED SCREWDRIVERS GENERATE HEAT WHEN INSTALLING SCREWS. IF YOU ARE USING A POWERED SCREWDRIVER, INSTALL TO 75% DEPTH AND LET THE PLASTIC COOL OFF. HAND TIGHTEN TO 100%.**

**STRIPPED HOLES ARE NOT COVERED UNDER WARRANTY!**

**Please read this entire instruction book prior to assembly**



F-BH40 - (2)  
M3x40mm Button Head



F-BH35 - (2)  
M3x35mm Button Head



F-BH25 - (4)  
M3x25mm Button Head



F-BH20 - (3)  
M3x20mm Button Head



F-BH18 - (3)  
M3x18mm Button Head



F-BH16 - (2)  
M3x16mm Button Head



F-BH12 - (12)  
M3x12mm Button Head



F-BH10 - (12)  
M3x10mm Button Head



F-BH08 - (2)  
M3x8mm Button Head



F-BH06 - (3)  
M3x6mm Button Head



F-EC04 - (3)  
4mm E Clip



C-SP33 - (1)  
3x3 Spacer



D-SP55 - (1)  
5x5 Spacer



F-FW04 - (1)  
4mm Flat Washer



F-SS16 - (4)  
M3x16mm Set Screw

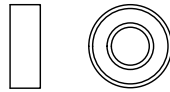

D-B5114 - (5)  
5x11x4 Bearing



D-B4104-F - (1)  
4x10x4 Bearing Flanged



D-B5104-F - (1)  
5x10x4 Bearing Flanged



F-LN03 - (5)  
3mm Locknut



F-LN04 - (1)  
M4mm Lock Nut

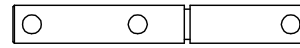

D-TCBS - (1)  
Transfer Case Bottom Shaft

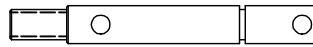

D-TS - (1)  
Transmission Shaft

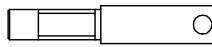

D-TCTS - (1)  
Transfer Case Top Shaft



C-SP70 - (3)  
M3x70mm Chassis Spacer

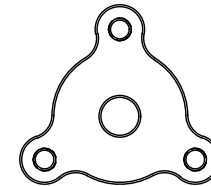

D-NGSA - (1)  
Spur Adapter v2

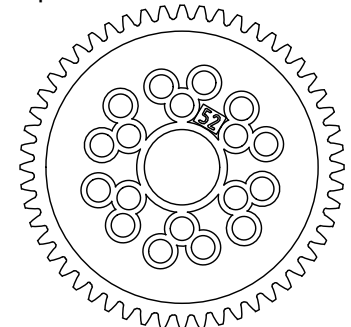

D-SG52 - (1)  
Incision 52t Spur



D-DP10 - (2)  
2.5mm x 10mm Dowel Pin

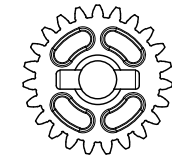

D-PX-GEAR-23 - (1)  
23t Bottom Gear



D-PX-GEAR-12 - (1)  
12t Top Gear

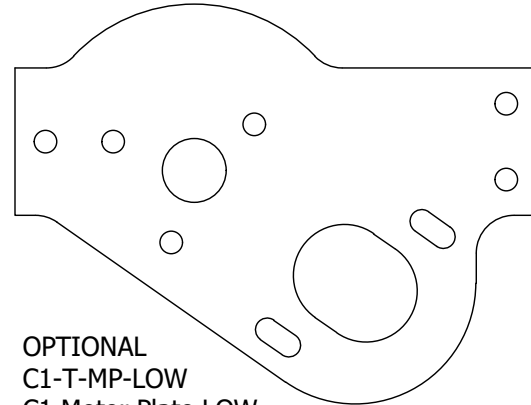

OPTIONAL  
C1-T-MP-LOW  
C1 Motor Plate LOW

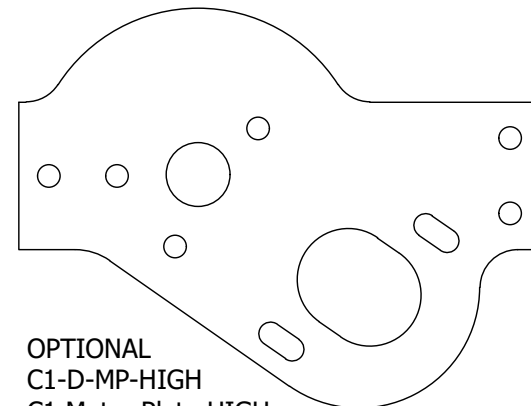

OPTIONAL  
C1-D-MP-HIGH  
C1 Motor Plate HIGH

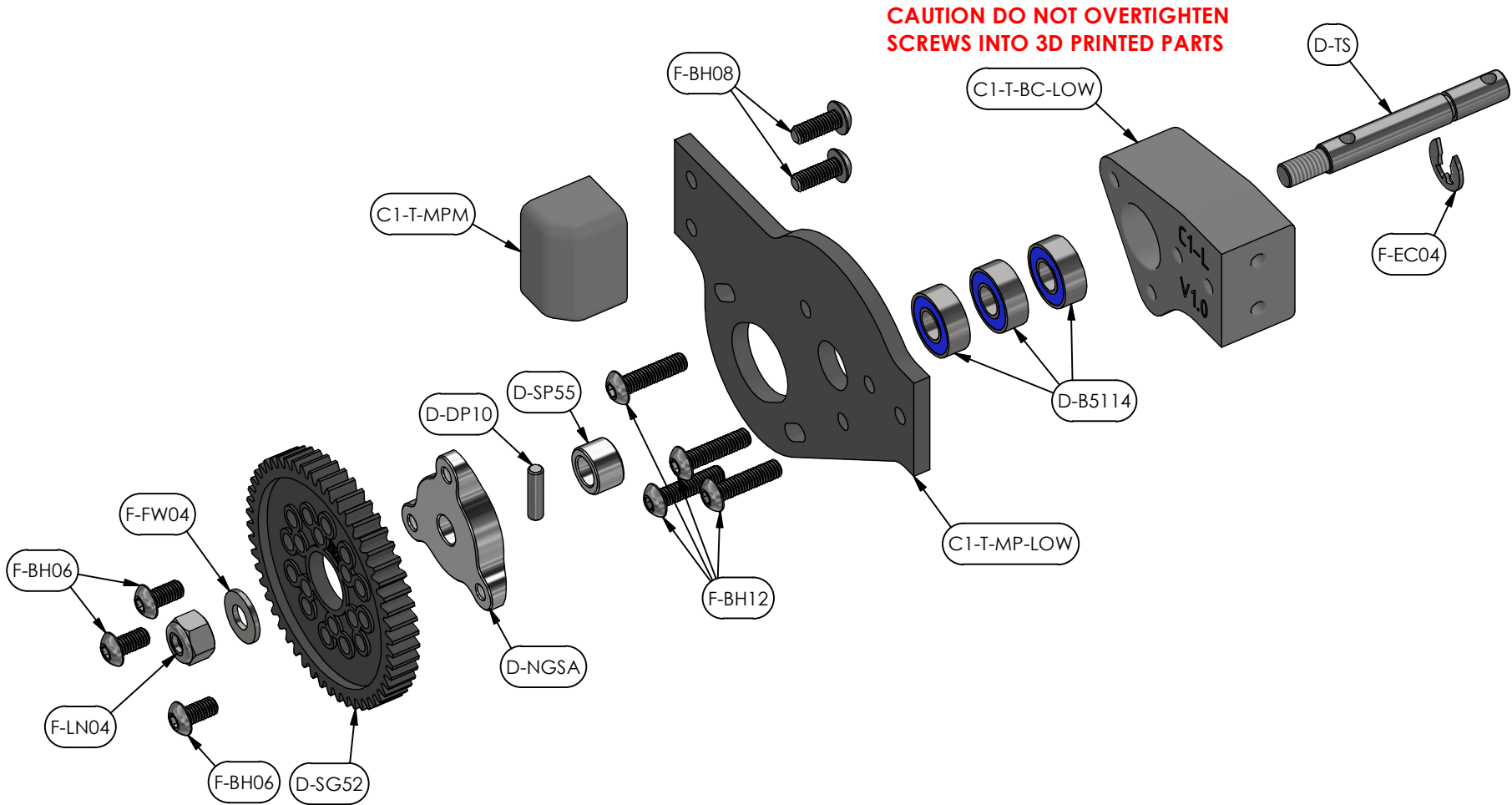

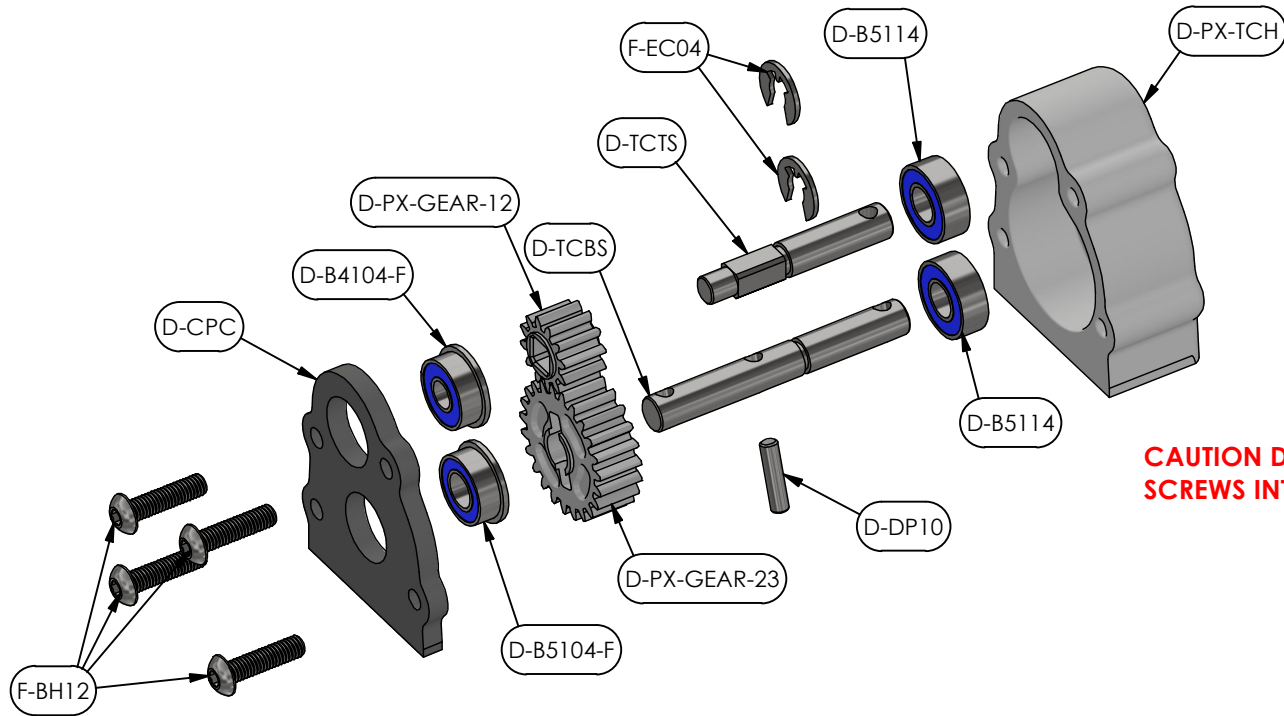

**CAUTION DO NOT OVERTIGHTEN  
SCREWS INTO 3D PRINTED PARTS**

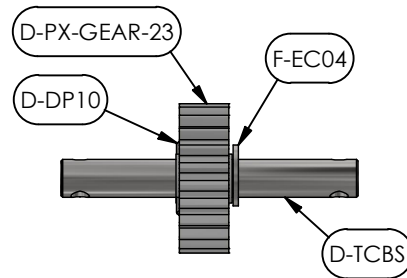

**BOTTOM SHAFT ASSEMBLY ORDER:**

- 1. CROSS PIN**
- 2. GEAR**
- 3. E-CLIP**

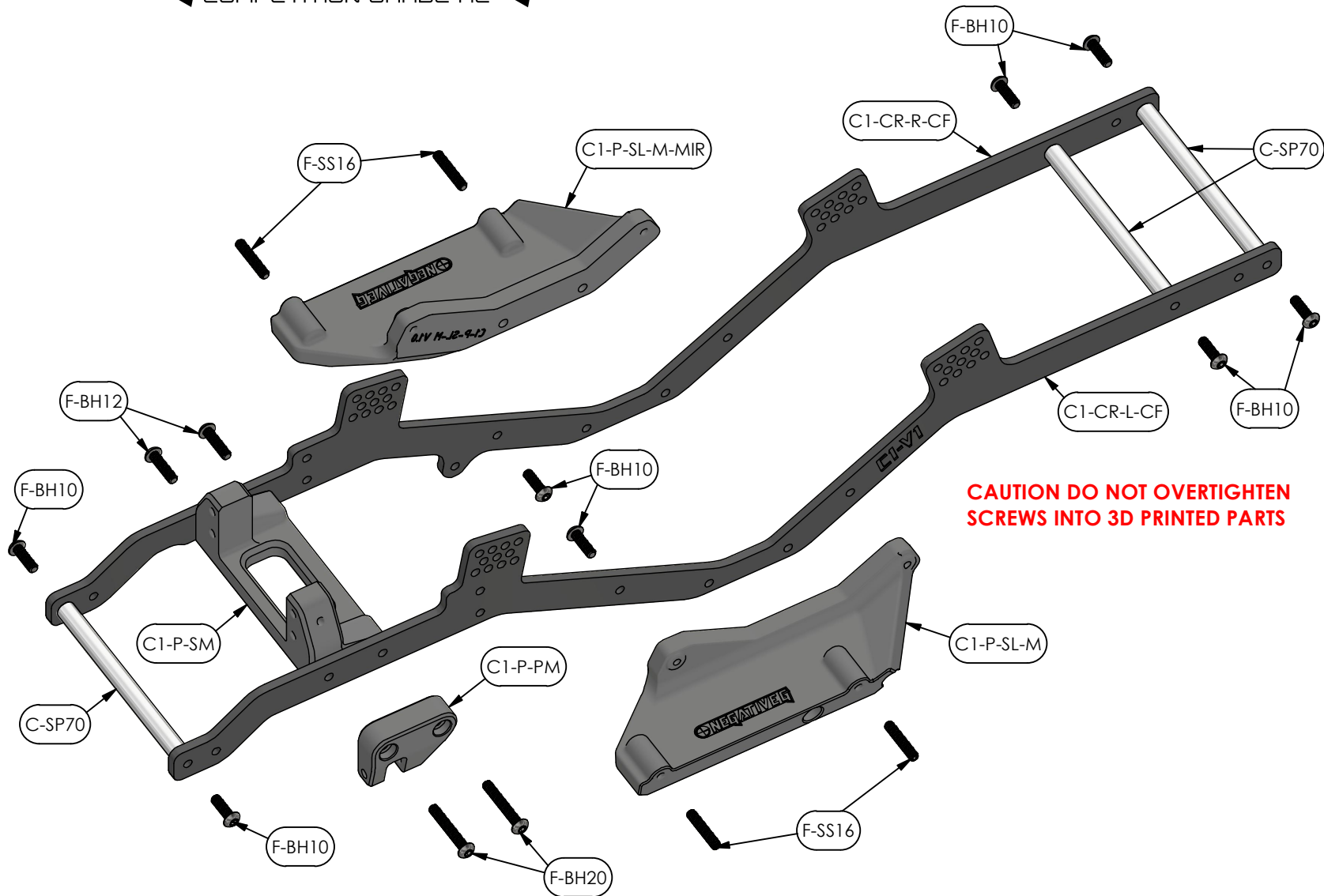

**CAUTION DO NOT OVERTIGHTEN  
SCREWS INTO 3D PRINTED PARTS**

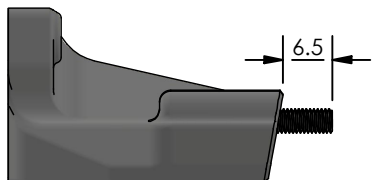

**F-SS16 SHOULD BE PARALLEL  
WITH BOTTOM OF SLIDER**

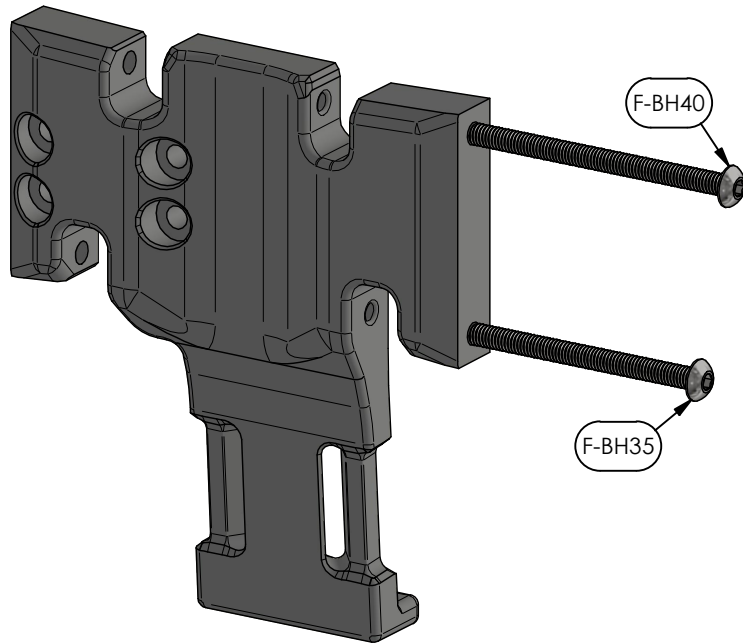

**USING A POWERED SCREWDRIVER INSTALL (1) LINK SCREW AT A TIME FULL DEPTH INTO EACH SKID PLATE LINK SCREW HOLE (F-BH40 FOR REAR, F-BH35 FOR FRONT). DO THIS IN STEPS TO AVOID OVERHEATING THE PLASTIC. INSTALL 30% AND LET COOL, REPEAT TO 60%, THEN TO 90% AND FINALLY FULL DEPTH.**

**AFTER EACH HOLE HAS BEEN THREADED AND THE SCREW REMOVED, USE AN ALLEN KEY OR COMPRESSED AIR TO CLEAN THE DEBRIS OUT OF THE HOLE, THEN MOVE ON TO THE NEXT ONE. SKIPPING THIS STEP MAY CAUSE THE SCREWS TO BIND INSIDE THE HOLE WHICH WILL PREVENT REMOVAL AND VOID THE WARRANTY.**

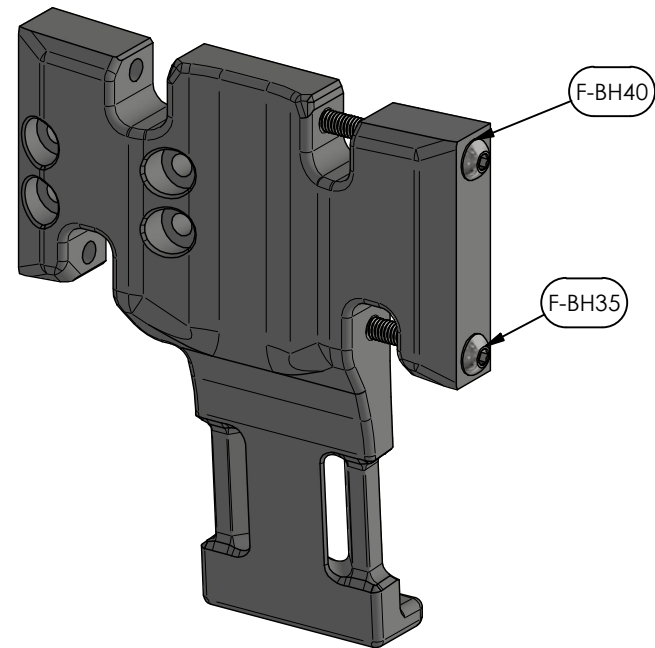

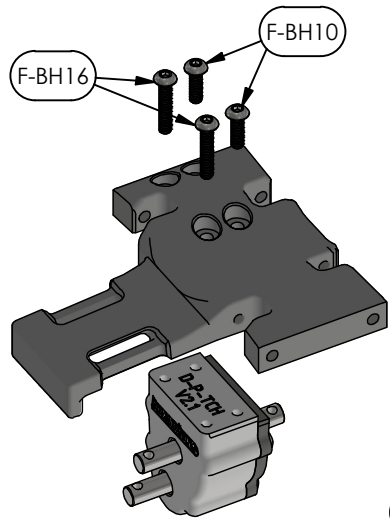

**CAUTION DO NOT OVERTIGHTEN  
SCREWS INTO 3D PRINTED PARTS**

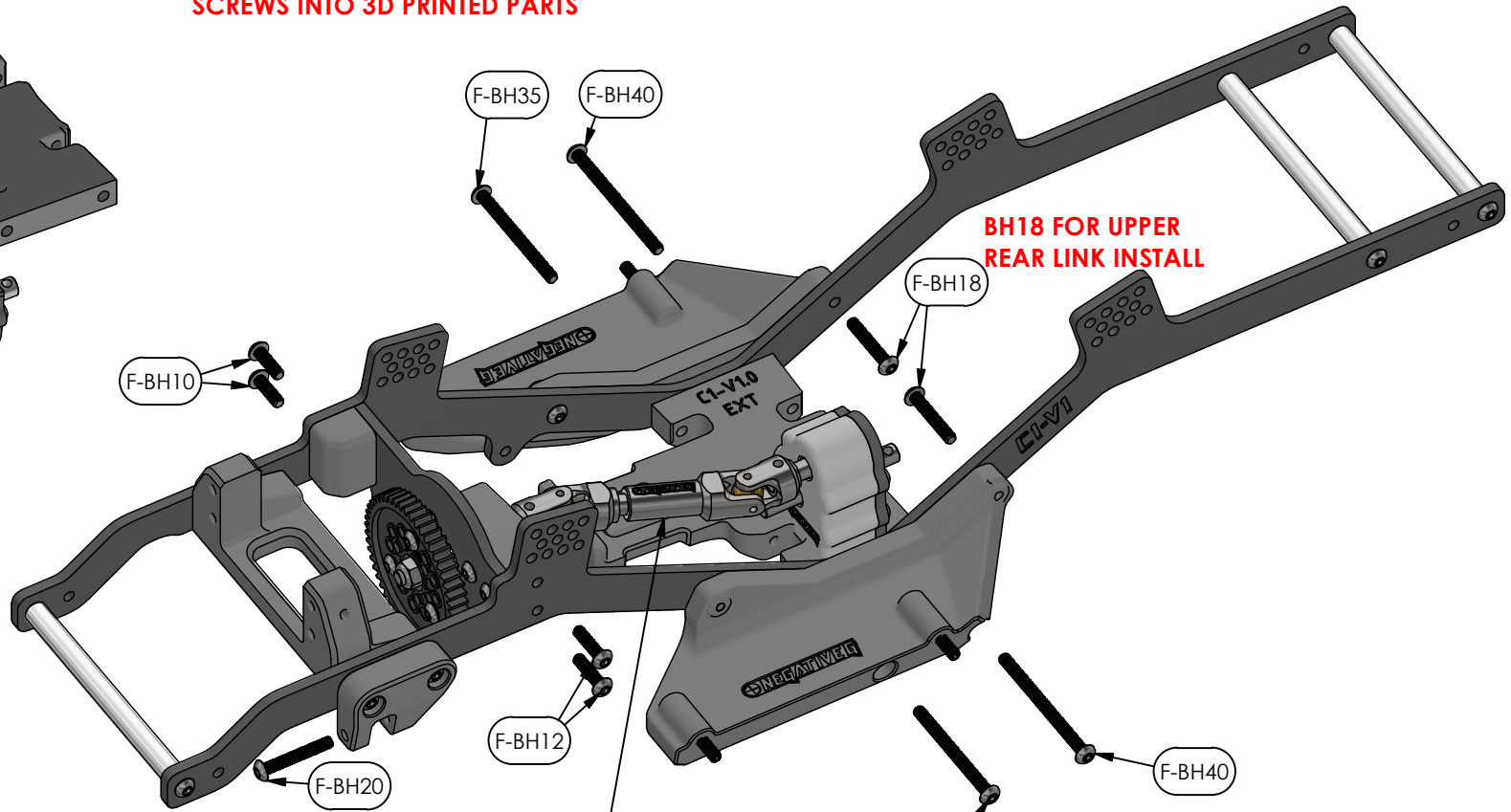

**BH18 FOR UPPER  
REAR LINK INSTALL**

**INSTALL PROPSHAFT HALVES TO PRIMARY DRIVE AND  
TRANSFER CASE PRIOR TO TRANSFER CASE INSTALL.  
CHECK FOR CORRECT PROPSHAFT UJOINT PHASING**

**BH35/40 FOR  
LOWER LINK  
INSTALL**

**CORRECT PHASING**

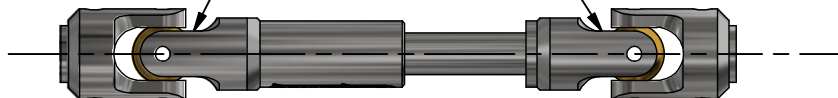

## LINK LENGTHS FOR TRX4 AXLES

ALL LENGTHS ARE APPROXIMATE. HIGHLY RECOMMENDED TO ORDER  
1+- MM SHORTER FOR ADJUSTMENT

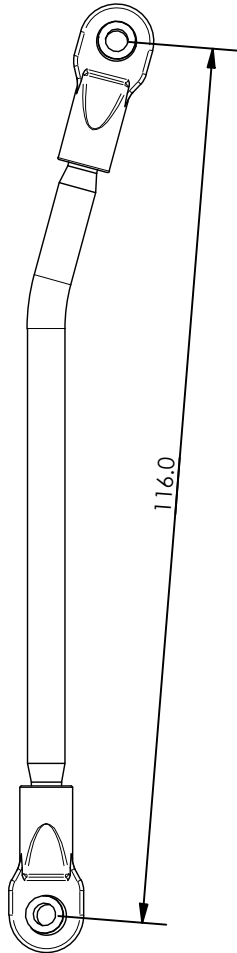

FRONT AND REAR  
LOWER LINK  
QTY (4)

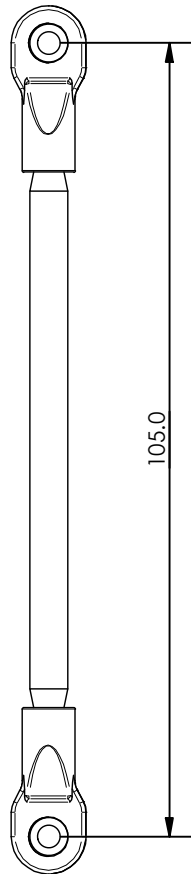

UPPER REAR LINK  
QTY (2)

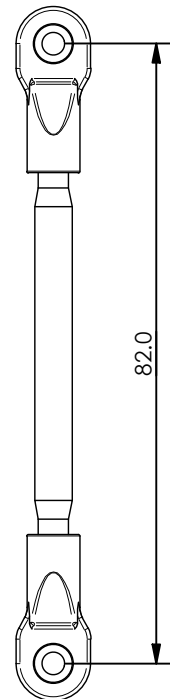

UPPER FRONT LINK  
QTY (1)

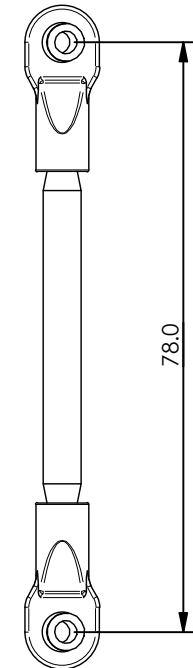

PANHARD LINK  
QTY (1)



## LINK LENGTHS FOR AR45 AXLES

ALL LENGTHS ARE APPROXIMATE. HIGHLY RECOMMENDED TO ORDER  
1+- MM SHORTER FOR ADJUSTMENT

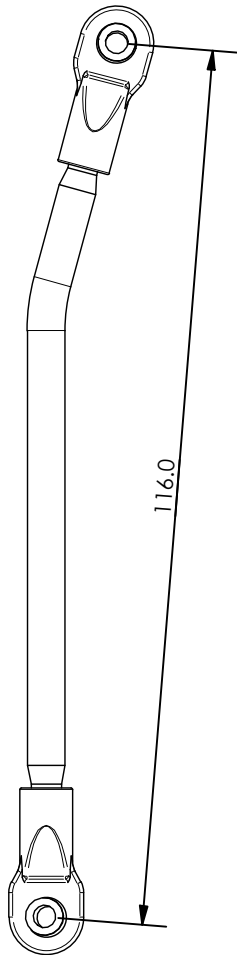

FRONT AND REAR  
LOWER LINK  
QTY (4)

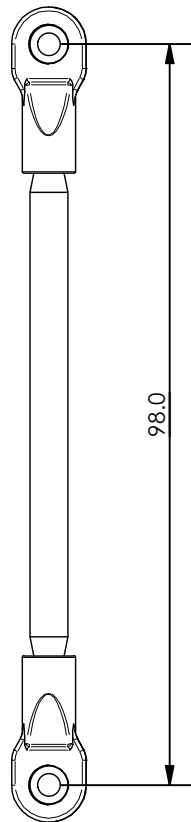

UPPER REAR LINK  
QTY (2)

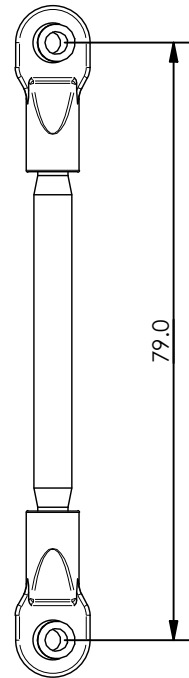

UPPER FRONT LINK  
QTY (1)

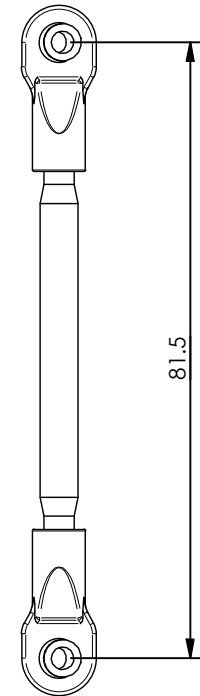

PANHARD LINK  
QTY (1)

## LINK LENGTHS FOR F10 AXLES

ALL LENGTHS ARE APPROXIMATE. HIGHLY RECOMMENDED TO ORDER 1+- MM SHORTER FOR ADJUSTMENT

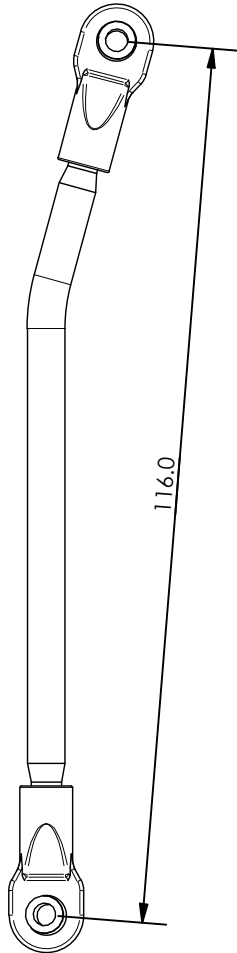

FRONT AND REAR  
LOWER LINK  
QTY (4)

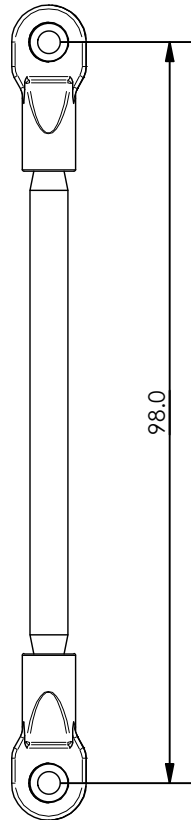

UPPER REAR LINK  
QTY (2)

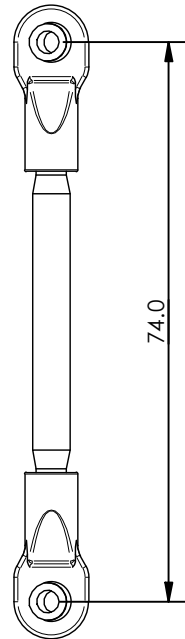

UPPER FRONT LINK  
QTY (1)

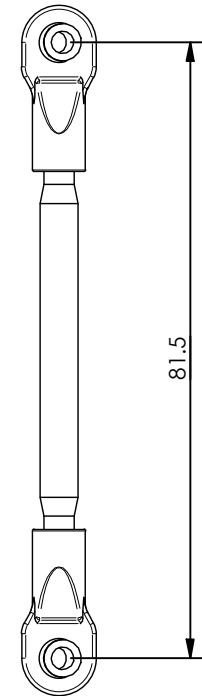

PANHARD LINK  
QTY (1)

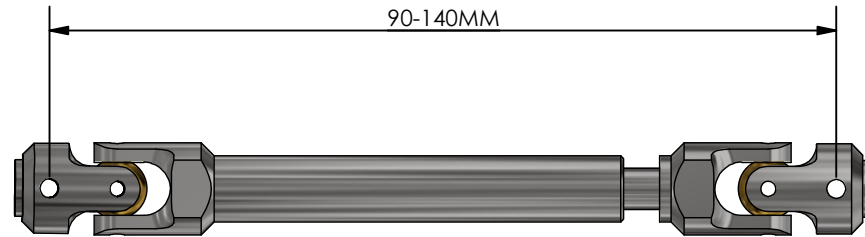

RECOMMENDED DRIVESHAFT  
FRONT AND REAR  
90MM - 140MM

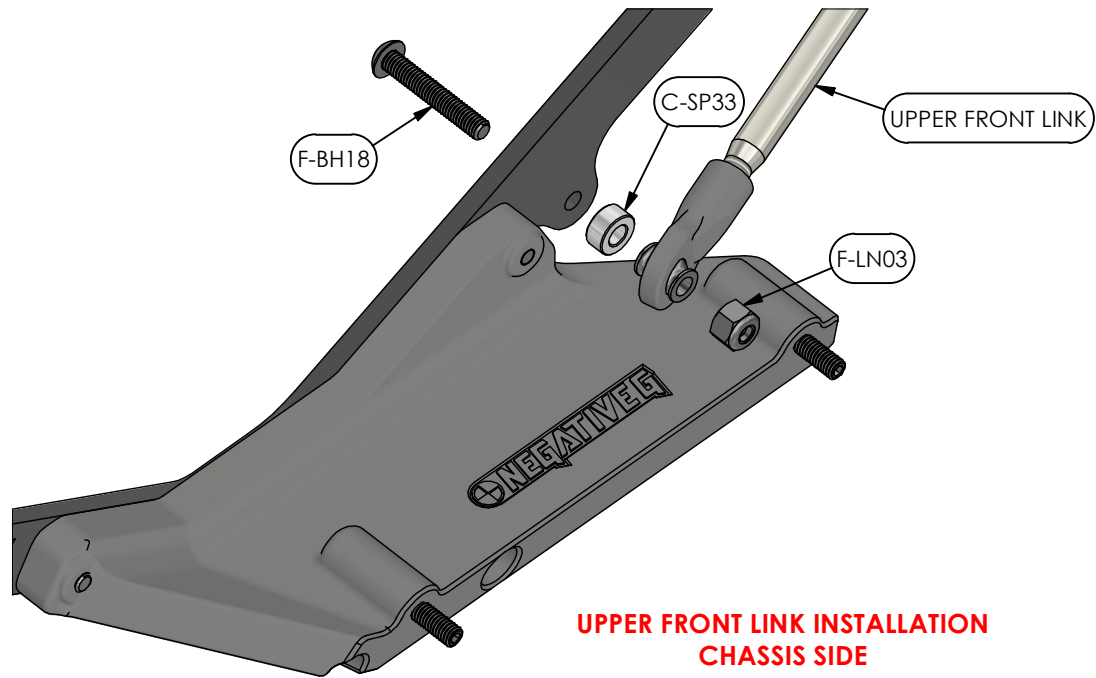

**UPPER FRONT LINK INSTALLATION  
CHASSIS SIDE**

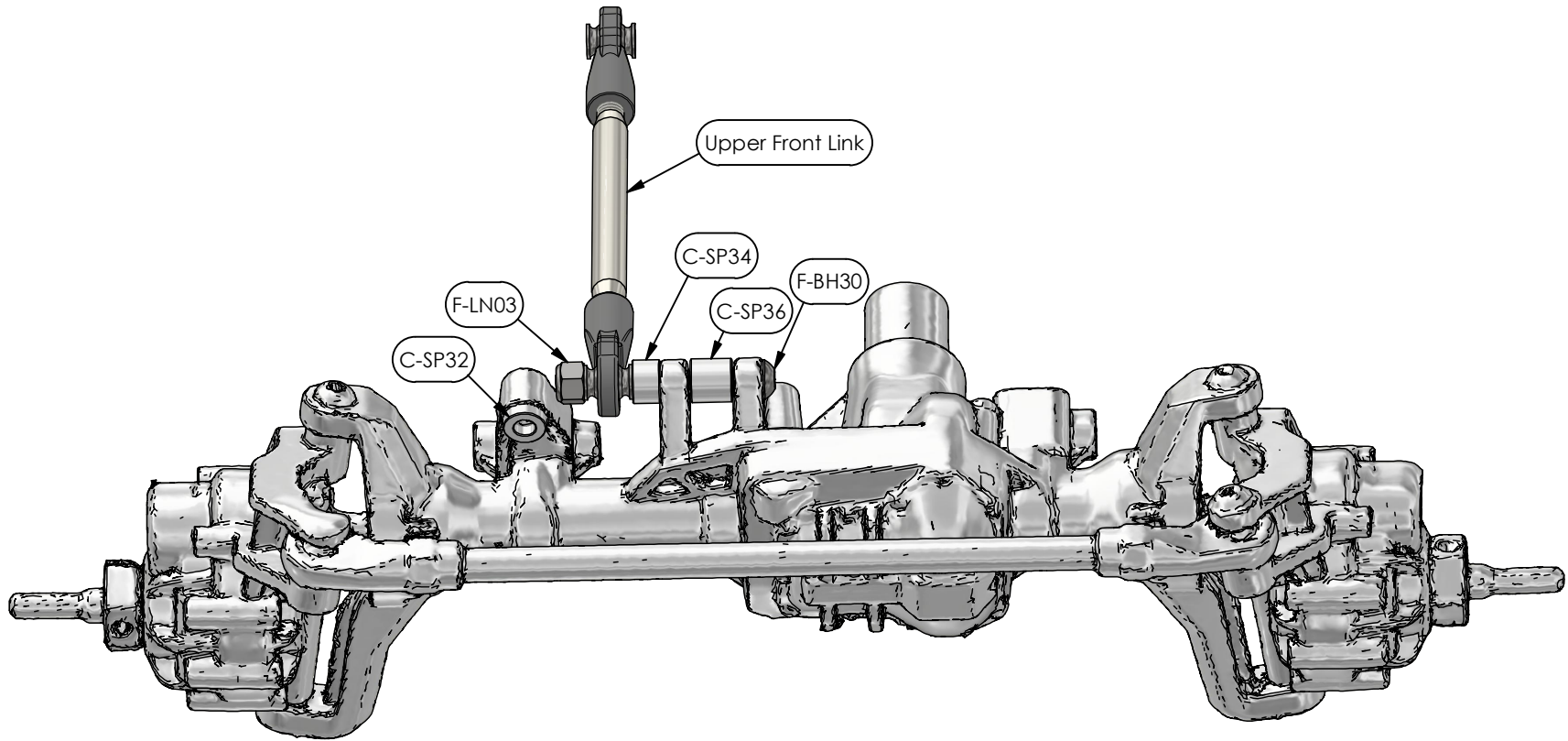

**TRX4 UPPER FRONT LINK INSTALLATION**  
**\*HARDWARE LOCATED IN MOTOR PLATE BAG**

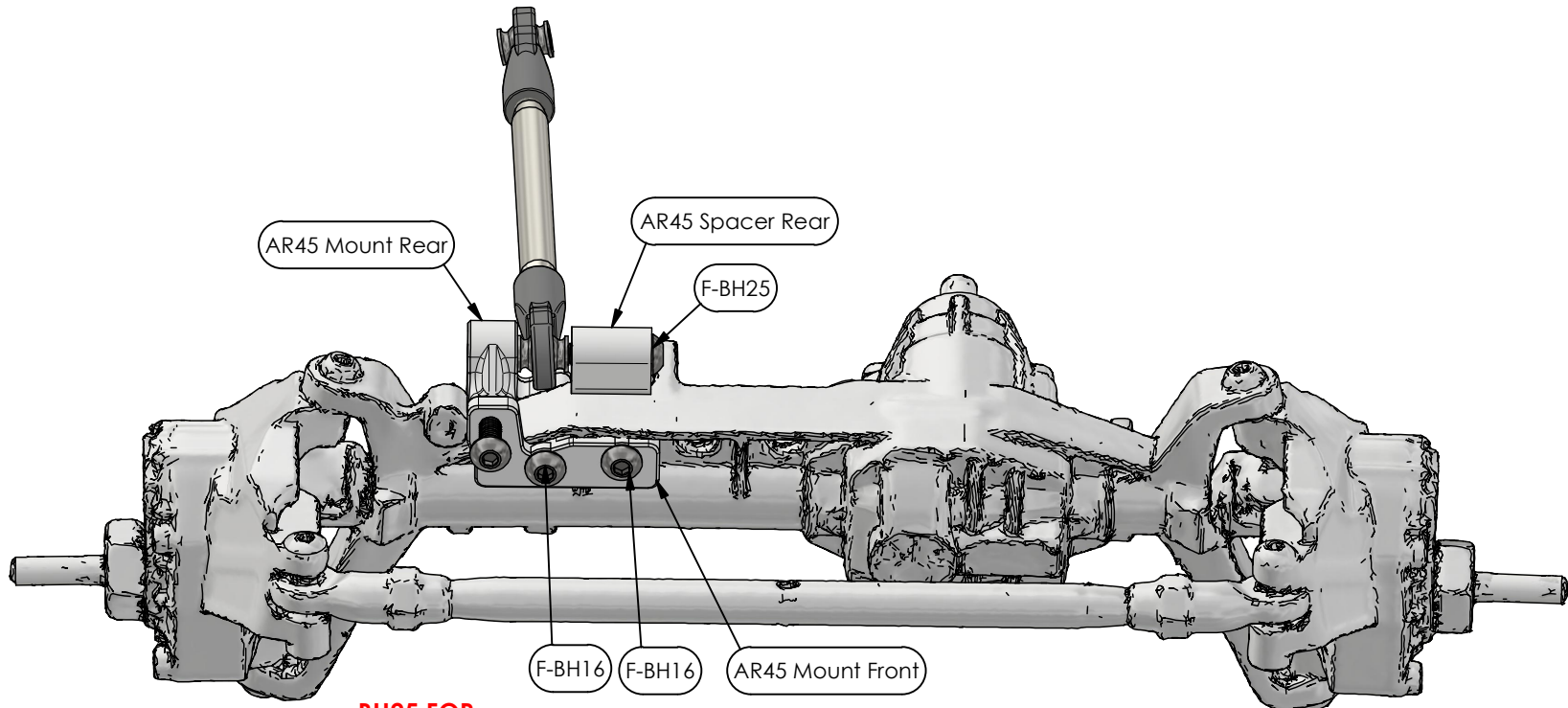

**BH25 FOR  
PANHARD**

**AR45 FRONT UPPER LINK INSTALLATION  
\*HARDWARE LOCATED IN MOTOR PLATE BAG**

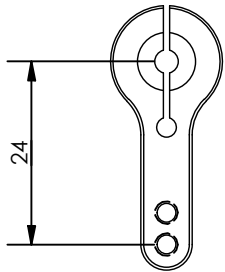

**MINIMUM 24MM SERVO  
HORN RECOMMENDED**

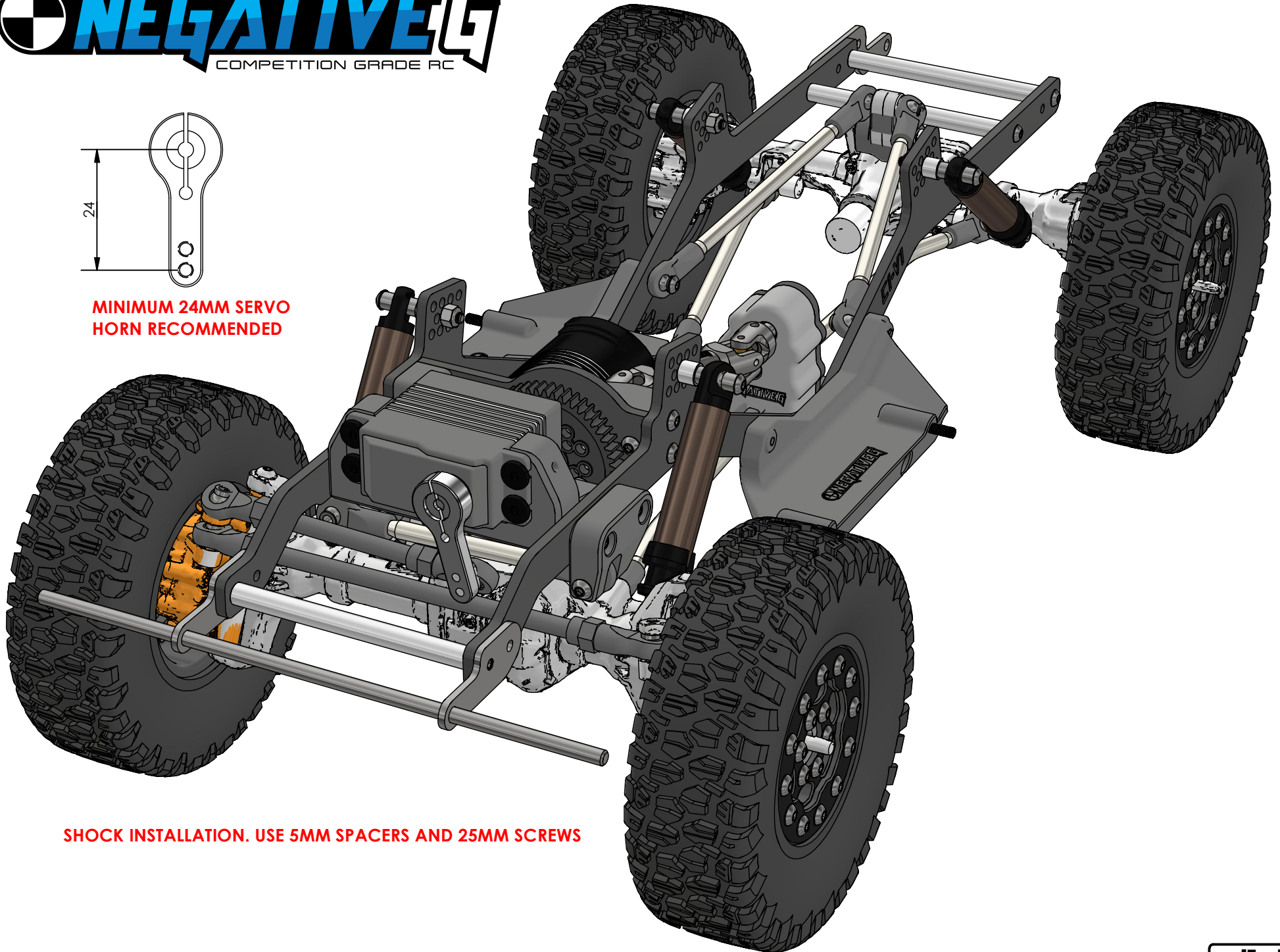

**SHOCK INSTALLATION. USE 5MM SPACERS AND 25MM SCREWS**





**RECOMMENDED SETUP**

- RUN AS FULL DROOP
- SOFT OR MEDIUM SPRINGS
- RUBBER BAND LIMIT STRAPS F&R

**DON'T LET GRAVITY WIN!**